

AL300ULX Series

Power Supply/Chargers

Altronix AL300ULX series power supply/chargers convert a 115VAC, 60Hz input into a single fused, four (4), eight (8) or sixteen (16) fuse or PTC protected outputs. Outputs are selectable for 12VDC or 24VDC with a total of 2.5A max.



AL300ULPD8

Key Features

- Available with 1, 4, 8 or 16 outputs
- Fused or PTC protected outputs
- Supervision:
 - AC Fail
 - Battery Fail and Battery Presence
- Built-in charger for sealed lead acid or gel type batteries
- Instantaneous transfer to stand-by batteries
- Short circuit and overload protection
- AC input and DC output options
- UL Listed in the U.S. and Canada
- CSFM and MEA Approved
- Lifetime Warranty
- All units are available in grey or red enclosure*

*AL300ULXJ's enclosure is red. For grey enclosure order model AL300ULXJG

AL300ULX series Power Supply Configuration Reference Chart

Altronix Model Number	Input Rating: 115VAC, 60Hz	Input Fuse Rating	Power Supply Output Fuse Rating	Total Output Rating (A)	Power Distribution Module	Number of Outputs	Fused Outputs Ratings	PTC Auto-Resettable Outputs Ratings	Accommodates Batteries				
AL300ULX	3.5A	5A/250V	15A/32V	2.5A	N/A	1	3.5A	-	Two (2) 7AH				
AL300ULXX									Two (2) 12AH				
AL300ULXJ(G)									Two (2) 18AH				
AL300ULPD4					PD4UL	4	3.5A	-	Two (2) 7AH				
AL300ULXPD4									Two (2) 12AH				
AL300ULPD4CB					PD4ULCB	4	-	2.5A	Two (2) 7AH				
AL300ULXPD4CB									Two (2) 12AH				
AL300ULPD8					PD8UL	8	3.5A	-	Two (2) 7AH				
AL300ULXPD8									Two (2) 12AH				
AL300ULPD8CB									PD8ULCB	8	-	2.5A	Two (2) 7AH
AL300ULXPD8CB													Two (2) 12AH
AL300ULXPD16					Two (2) PD8UL	16	3.5A	-	Two (2) 12AH				
AL300ULXPD16CB					Two (2) PD8ULCB	16	-	2.5A	Two (2) 12AH				

Lifetime Warranty



AL300ULX Series

Power Supply/Chargers

Specifications

Input

Voltage 115VAC, 60Hz, 3.5A max.
Fusing 5A / 250V

Outputs

Voltage 12VDC or 24VDC selectable
Current 2.5A power-limited continuous max.
Protection Fused 3.5A / PTC 2.5A
Other Overvoltage protection
Filtered and regulated
PTC protected outputs are auto-resettable

Battery Charging

Capacity 7AH/12VDC (1 or 2 within enclosure)
12AH/12VDC (requires larger "X" enclosure)
18AH/12VDC (requires larger "J" enclosure)
40AH/65AH (requires separate enclosure)
Type Sealed lead acid or gel type
Fuse Rating 15A/32V
Failover Upon AC loss, instantaneous
Batteries are sold separately

Supervision

AC Failure Form "C" contacts
Battery Form "C" contacts

Indicators (LED)

Input 115VAC is present
DC Output Powered
Battery Discharged or not connected

Agency Listings

All Models:

UL:
UL294 Access Control System Units
UL603 Power Supplies for Use with Burglar-Alarms Systems
UL 1069 UL Listed Hospital Signaling and Nurse Call Equipment
UL1481 Power Supplies for Fire Protective Signaling Systems

cUL:

CSA C22.2 No.205 Signal Equipment
CSA Standard C603-M1988 Burglar Alarm System

AL300ULX, AL300ULXX and AL300ULXJ only:

CSFM California State Fire Marshall Approved

Physical and Environmental

Dimensions (H x W x D)

AL300ULX, AL300ULPD4(CB), AL300ULPD8(CB):

Enclosure: 13.5" x 13" x 3.25" (342.9mm x 330.2mm x 82.55mm)
Shipping: 15" x 13.875" x 4.75" (381mm x 352.4mm x 120.6mm)

AL300ULXX, AL300ULXPD4(CB),

AL300ULXPD8(CB), AL300ULXPD16(CB):

Enclosure: 15.5" x 12" x 4.5" (393.7mm x 304.8mm x 114.3mm)
Shipping: 16.5" x 13.5" x 6" (419.1mm x 342.9mm x 152.5mm)

AL300ULXJ(G):

Enclosure: 18" x 14.5" x 4.625" (457.2mm x 368.3mm x 117.5mm)
Shipping: 21.75" x 18.25" x 5.75" (552.5mm x 463.6mm x 146.1mm)

Weight (approx.)

Model	Product Weight	Shipping Weight
AL300ULX	6.65 lb. (3.1 kg)	8.45 lb. (3.83 kg)
AL300ULXX	8.25 lb. (3.75 kg)	10.55 lb. (4.79 kg)
AL300ULXJ(G)	11.5 lb. (5.22 kg)	13.7 lb. (6.21 kg)
AL300ULPD4(CB)	6.8 lb. (3.1 kg)	8.6 lb. (3.9 kg)
AL300ULXPD4(CB)	8.4 lb. (3.81 kg)	10.65 lb. (4.83 kg)
AL300ULPD8(CB)	6.9 lb. (3.13 kg)	8.7 lb. (3.95 kg)
AL300ULXPD8(CB)	8.45 lb. (3.83 kg)	10.7 lb. (4.85 kg)
AL300ULXPD16(CB)	8.55 lb. (3.88 kg)	10.85 lbs. (4.92 kg)

Temperature

Operating: 0°C to 49°C (32°F to 120°F)
Storage: - 20°C to 70°C (- 4°F to 158°F)

Relative Humidity

85% +/- 5%

BTU/Hr (approx.)

12VDC: 17 BTU/Hr.
24VDC: 32 BTU/Hr.

Lifetime Warranty

Altronix Corporation | 140 58th St | Brooklyn, NY 11220 USA

phone: +1 718.567.8181 | fax: +1 718.567.9056 | email: info@altronix.com | www.altronix.com

AL300ULX Series

Power Supply/Chargers

Dimensions and Drawing

AL300ULX, AL300ULPD4(CB), AL300ULPD8(CB) Dimensions (H x W x D approximate)

13.5" x 13" x 3.25" (342.9mm x 330.2mm x 82.6mm)

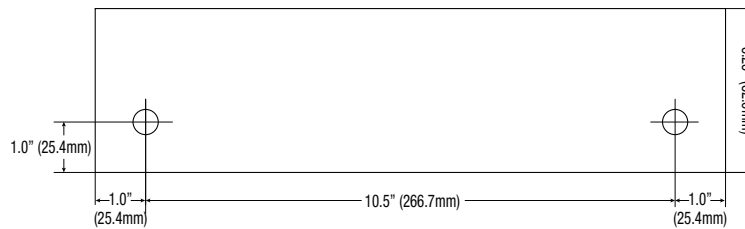
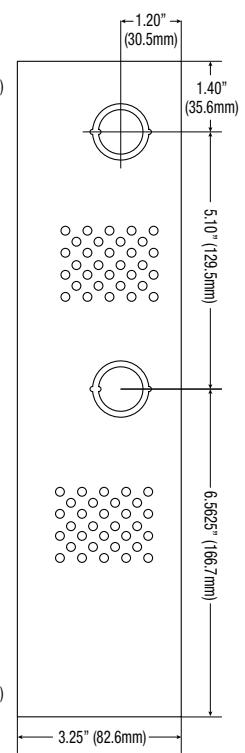
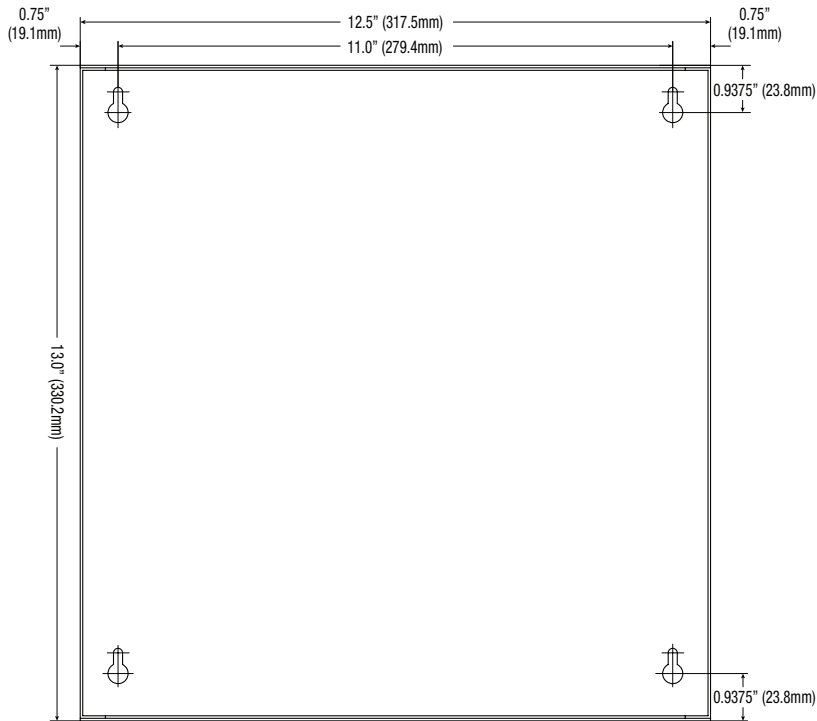
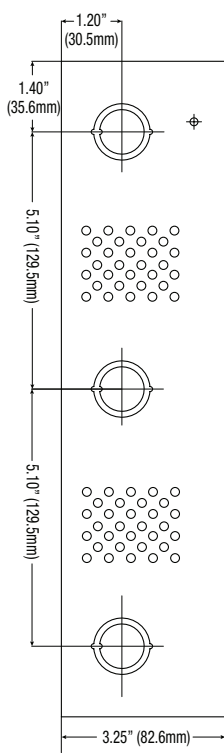
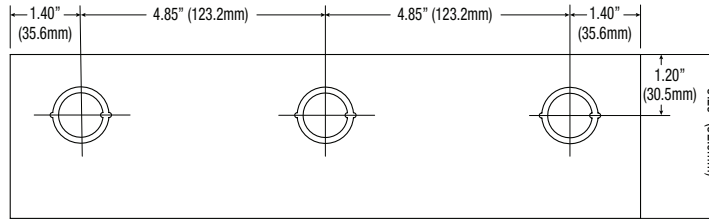

Lifetime Warranty

Altronix Corporation | 140 58th St | Brooklyn, NY 11220 USA

phone: +1 718.567.8181 | fax: +1 718.567.9056 | email: info@altronix.com | www.altronix.com

Dimensions and Drawing

AL300ULXX, AL300ULXPD4(CB), AL300ULXPD8(CB), AL300ULXPD16(CB) Dimensions (H x W x D approximate)
 15.5" x 12" x 4.5" (393.7mm x 304.8mm x 114.3mm)

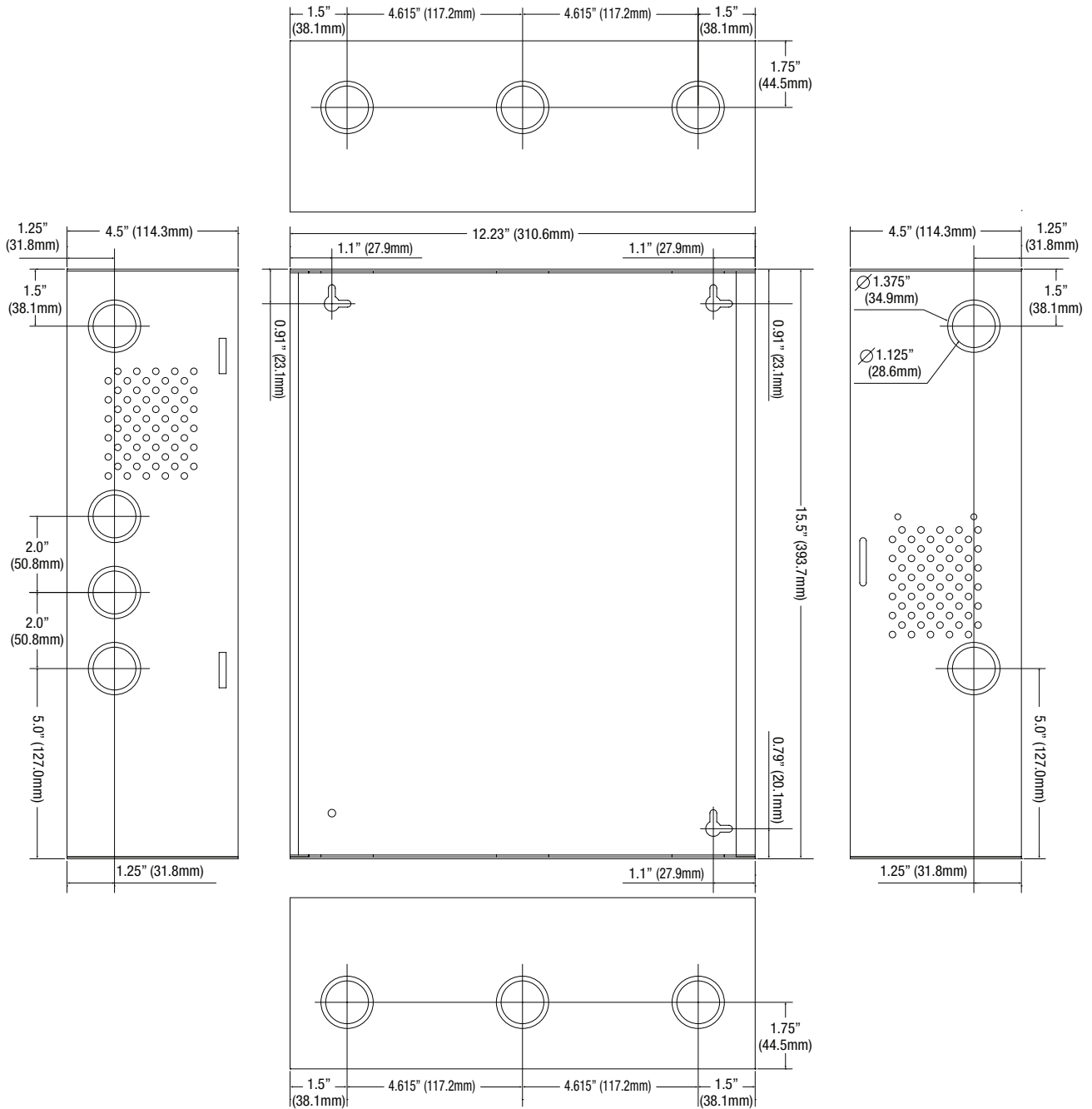

Lifetime Warranty

Altronix Corporation | 140 58th St | Brooklyn, NY 11220 USA

phone: +1 718.567.8181 | fax: +1 718.567.9056 | email: info@altronix.com | www.altronix.com

Dimensions and Drawing

AL300ULXJ(G) Dimensions (H x W x D approximate)

18" x 14.5" x 4.625" (457.2mm x 368.3mm x 117.5mm)

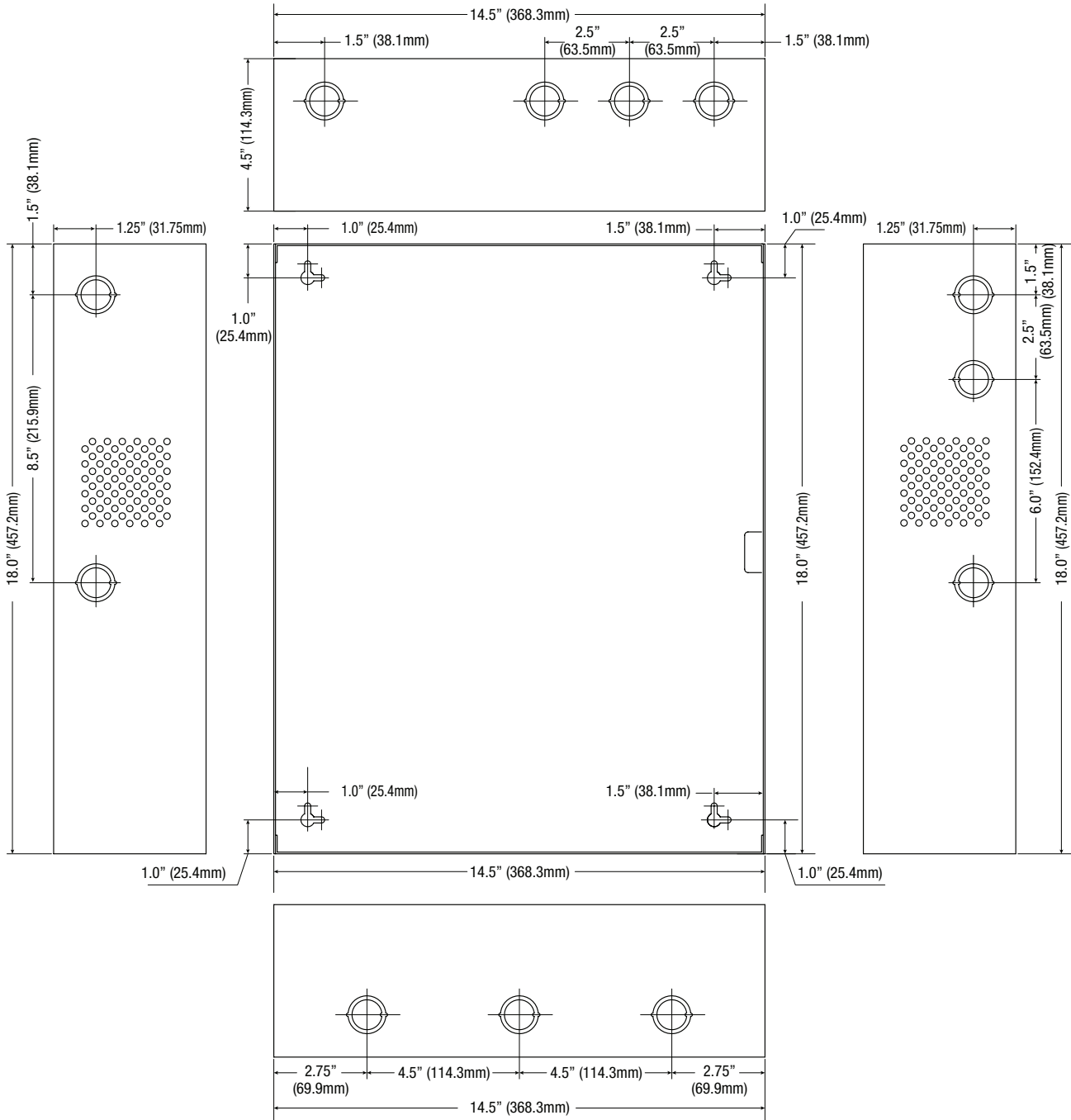

Lifetime Warranty

Altronix Corporation | 140 58th St | Brooklyn, NY 11220 USA

phone: +1 718.567.8181 | fax: +1 718.567.9056 | email: info@altronix.com | www.altronix.com