

AL400X220 Series

Power Supply/Chargers

Altronix AL400X220 series power supply/chargers convert a 220VAC (working range 198VAC - 256VAC), 50/60Hz input into a single fused, four (4), eight (8) or sixteen (16) fuse/PTC protected outputs. Outputs are selectable for 12VDC with a total of 4A max. or 24VDC with a total of 3A max.



AL400PD8220

Key Features

- Available with 1, 4, 8 or 16 outputs
- Fused or PTC protected outputs
- Supervision
 - AC Fail
 - Battery Fail and Battery Presence
- Built-in charger for sealed lead acid or gel type batteries
- Instantaneous transfer to stand-by batteries
- Short circuit and overload protection
- AC input and DC output options.
- CE European Conformity
- Lifetime Warranty
- All units are available in grey or red enclosure

AL400X220 Series Power Supply Configuration Reference Chart

Altronix Model Number	12VDC Total Output Rating (A)	24VDC Total Output Rating (A)	Input Rating: 220VAC, 50/60Hz	Power Supply Input Fuse Rating	Power Supply Battery Fuse Rating	Power Distribution Module(s)	Number of Outputs	Fused Outputs Ratings	PTC Auto-Resettable Outputs Ratings	Accommodates Batteries
AL400X220	4A	3A	1.5A	5A/250V	15A/32V	N/A	1	3.5A	-	Two (2) 7AH
AL400XX220										Two (2) 12AH
AL400XJ220										Two (2) 18AH
AL400PD4220						PD4	4	3.5A	-	Two (2) 7AH
AL400XP4220										Two (2) 12AH
AL400PD4CB220						PD4CB	4	-	2.5A	Two (2) 7AH
AL400XP4CB220										Two (2) 12AH
AL400PD8220						PD8	8	3.5A	-	Two (2) 7AH
AL400XP8220										Two (2) 12AH
AL400PD8CB220						PD8CB	8	-	2.5A	Two (2) 7AH
AL400XP8CB220										Two (2) 12AH
AL400XP16220						Two (2) PD8	16	3.5A	-	Two (2) 12AH
AL400XP16CB220										Two (2) 12AH
AL400XP16CB220						Two (2) PD8CB	16	-	2.5A	Two (2) 12AH
AL400XP16CB220	Two (2) 12AH									

Lifetime Warranty



AL400X220 Series

Power Supply/Chargers

Specifications

Input

Voltage 220VAC (working range 198VAC - 256VAC), 50/60Hz, 1.5A max.

Fusing 5A/250V

Outputs

Voltage 12VDC or 24VDC selectable.

Current 4A @ 12VDC or 3A @ 24VDC continuous max.

Protection Fused 3.5A / PTC 2.5A.

Other Overvoltage protection
Filtered and regulated

Battery Charging

Capacity 7AH/12VDC (1 or 2 within enclosure)
12AH/12VDC (requires larger "X" enclosure)
18AH/12VDC (requires larger "J" enclosure)
40AH/65AH (requires separate enclosure)

Type Sealed lead acid or gel type

Fuse Rating 15A/32VD

Failover Upon AC loss, instantaneous

Batteries are sold separately

Supervision

AC Failure Form "C" contacts

Battery Form "C" contacts

Indicators (LED)

Input 220VAC is present

DC Output Powered

Battery Discharged or not connected

Agency Listings

CE European Conformity

Physical and Environmental

Dimensions (H x W x D)

AL400X220, AL400PD4(CB)220, AL400PD8(CB)220:

Enclosure:

13.5" x 13" x 3.25" (342.9mm x 330.2mm x 82.55mm)

Shipping:

15" x 13.875" x 4.75" (381mm x 352.4mm x 120.6mm)

AL400XX220, AL400XPD4(CB)220, AL400XPD8(CB)220,

AL400XPD16(CB)220:

Enclosure:

15.5" x 12" x 4.5" (393.7mm x 304.8mm x 114.3mm)

Shipping:

16.5" x 13.5" x 6" (419.1mm x 342.9mm x 152.5mm)

AL400XJ220:

Enclosure:

18" x 14.5" x 4.625" (457.2mm x 368.3mm x 117.5mm)

Shipping:

21.75" x 18.25" x 5.75" (552.5mm x 463.6mm x 146.1mm)

Weight (approx.)

Model	Product Weight	Shipping Weight
AL400X220	6.95 lb. (3.15 kg)	8.75 lb. (4.0 kg)
AL400XX220	8.55 lb. (3.88 kg)	10.85 lb. (4.92 kg)
AL400XJ220	11.5 lb. (5.22 kg)	13.7 lb. (6.21 kg)
AL400PD4(CB)220	7.1 lb. (3.22 kg)	8.9 lb. (4.04 kg)
AL400XPD4(CB)220	8.7 lb. (3.95 kg)	11.0 lb. (5.0 kg)
AL400PD8(CB)220	7.2 lb. (3.27 kg)	9.0 lb. (4.08 kg)
AL400XPD8(CB)220	8.8 lb. (4.0 kg)	11.1 lb. (5.03 kg)
AL400XPD16(CB)220	8.85 lb. (4.01 kg)	11.15 lb. (5.1 kg)

Temperature

Operating: 0°C to 49°C (32°F to 120°F)

Storage: - 20°C to 70°C (- 4°F to 158°F)

Relative Humidity 85% +/- 5%

BTU/Hr (approx.) 12VDC: 25 BTU/Hr.

24VDC: 37 BTU/Hr.

Lifetime Warranty

Altronix Corporation | 140 58th St | Brooklyn, NY 11220 USA

phone: +1 718.567.8181 | fax: +1 718.567.9056 | email: info@altronix.com | www.altronix.com

AL400X220 Series

Power Supply/Chargers

Dimensions and Drawing

AL400X220, AL400PD4(CB)220, AL400PD8(CB)220 Dimensions (H x W x D approximate)

13.5" x 13" x 3.25" (342.9mm x 330.2mm x 82.6mm)

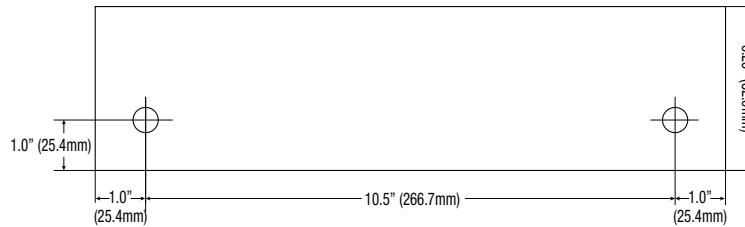
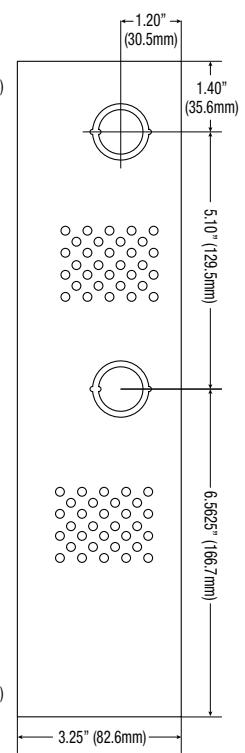
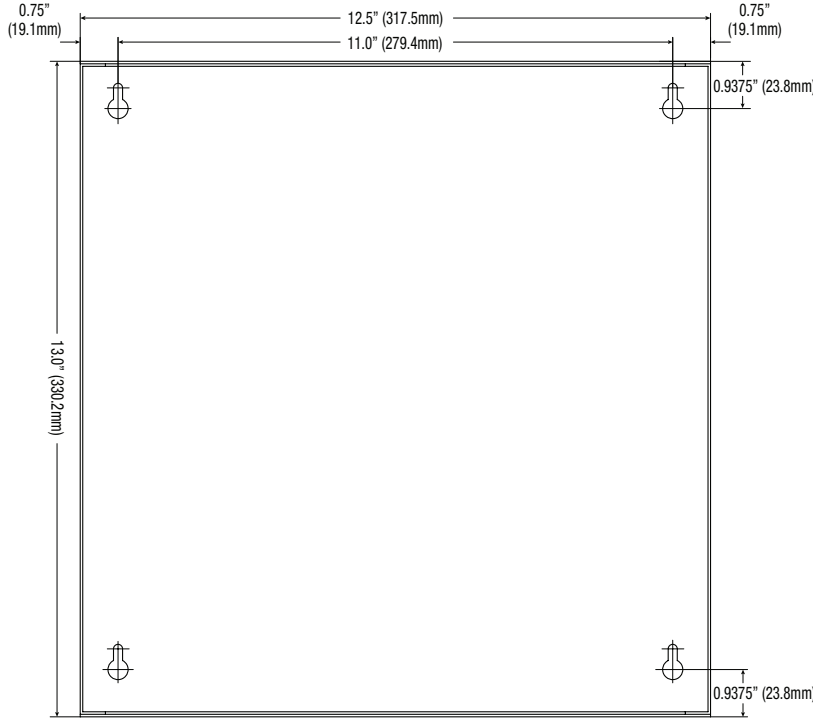
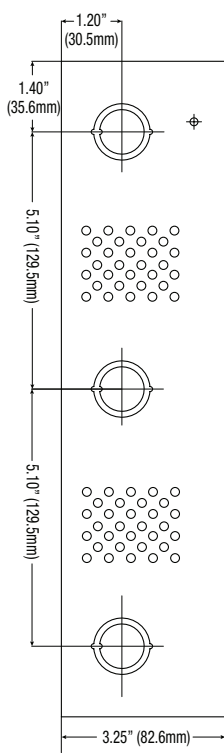
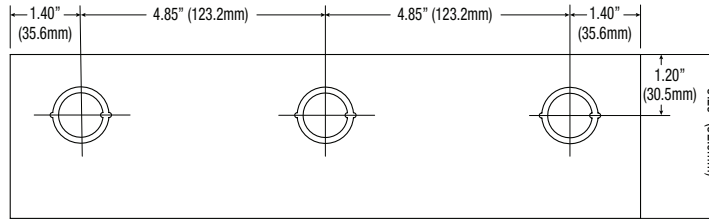

Lifetime Warranty

Altronix Corporation | 140 58th St | Brooklyn, NY 11220 USA

phone: +1 718.567.8181 | fax: +1 718.567.9056 | email: info@altronix.com | www.altronix.com

AL400X220 Series

Power Supply/Chargers

Dimensions and Drawing

AL400XX220, AL400XPD4(CB)220, AL400XPD8(CB)220, AL400XPD16(CB)220 Dimensions (H x W x D approximate)
15.5" x 12" x 4.5" (393.7mm x 304.8mm x 114.3mm)

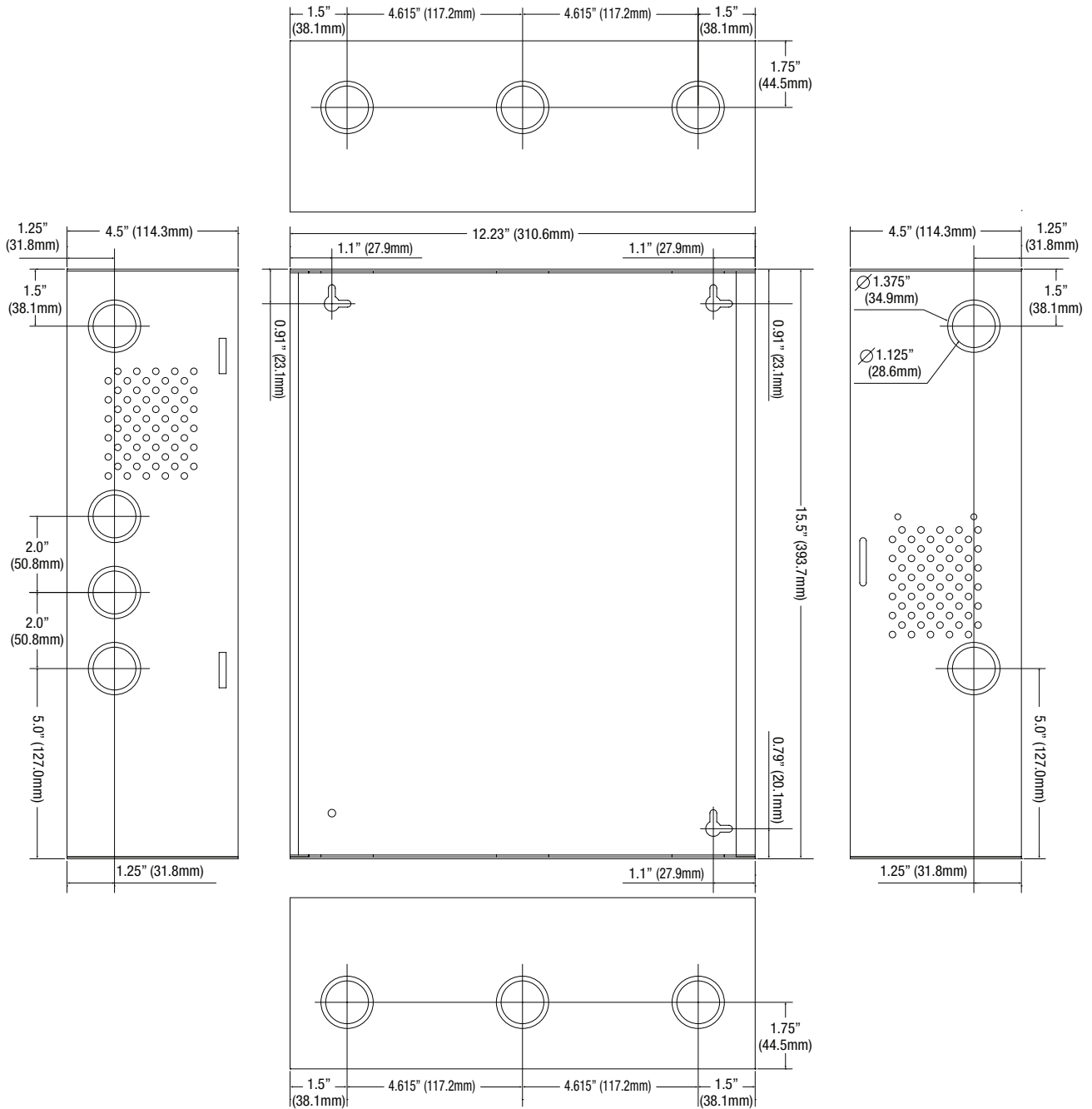

Lifetime Warranty

Altronix Corporation | 140 58th St | Brooklyn, NY 11220 USA

phone: +1 718.567.8181 | fax: +1 718.567.9056 | email: info@altronix.com | www.altronix.com

AL400X220 Series

Power Supply/Chargers

Dimensions and Drawing

AL400XJ220 Dimensions (H x W x D approximate)

18" x 14.5" x 4.625" (457.2mm x 368.3mm x 117.5mm)

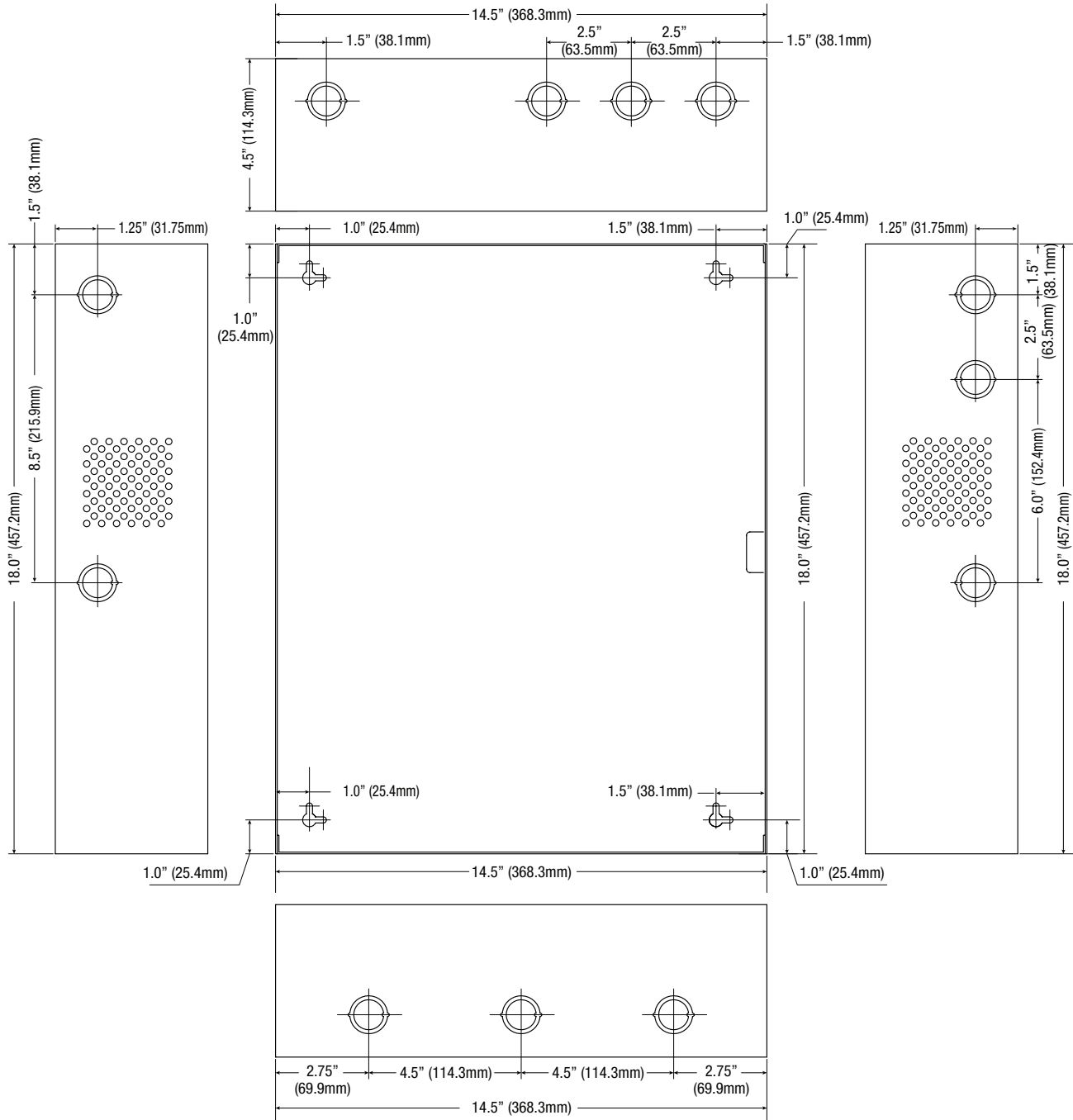

Lifetime Warranty

Altronix Corporation | 140 58th St | Brooklyn, NY 11220 USA

phone: +1 718.567.8181 | fax: +1 718.567.9056 | email: info@altronix.com | www.altronix.com