

LPS5C12X220

Linear Power Supply/Charger

Altronix LPS5C12X220 linear power supply/charger converts a 220VAC 50/60Hz input to a 12VDC, 3.5A continuous supply current. The output stays regulated until the battery discharges to 25% capacity.

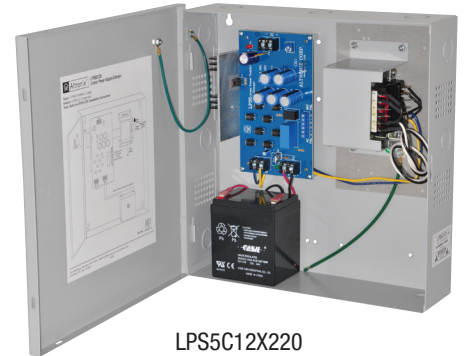

LPS5C12X220

Specifications

Input

Voltage 220VAC (working range 198VAC - 256VAC),
50/60Hz, 0.8A

Outputs

Voltage 12VDC
Current 3.5A continuous supply current
Other Short circuit and thermal overload protection
Filtered and regulated

Battery Charging

Capacity 7AH/12VDC (2 within enclosure)
40AH/65AH (requires separate enclosure)
Type Sealed lead acid or gel type
Failover Upon AC loss, instantaneous
Batteries are sold separately

Indicators (LED)

Input Input voltage is present
DC Output Powered

Supervision

AC Failure Form "C" contacts
Battery Low Form "C" contacts

Physical and Environmental

Dimensions (H x W x D)

Enclosure:
13.5" x 13" x 3.25" (342.9mm x 330.2mm x 82.55mm)
Shipping:
15" x 13.875" x 4.75" (381mm x 352.4mm x 120.6mm)
Enclosure accommodates up to two (2) 12VDC/7AH batteries

Weight (approx.)

Product: 11.4 lb. (5.17 kg)
Shipping: 12.4 lb. (5.62 kg)

Temperature

Operating: 0°C to 49°C (32°F to 120°F)
Storage: -20°C to 70°C (-4°F to 158°F)

Relative Humidity 85% +/- 5%

BTU/Hr (approx.) 22 BTU/Hr.

Lifetime Warranty

LPS5C12X220

Linear Power Supply/Charger

Dimensions and Drawing

Dimensions (H x W x D approximate)

13.5" x 13" x 3.25" (342.9mm x 330.2mm x 82.55mm)

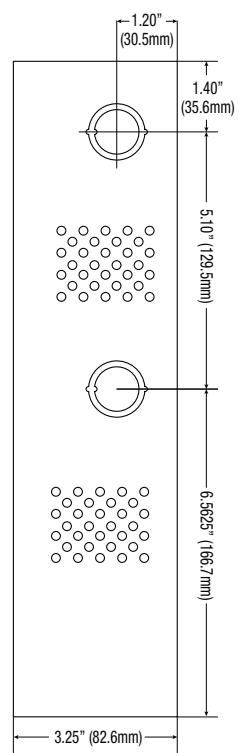
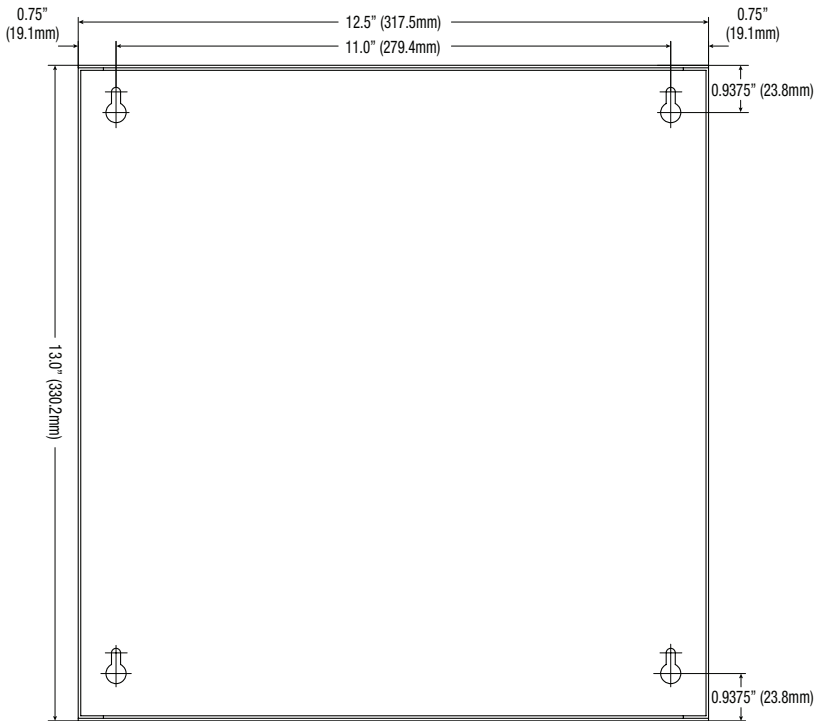
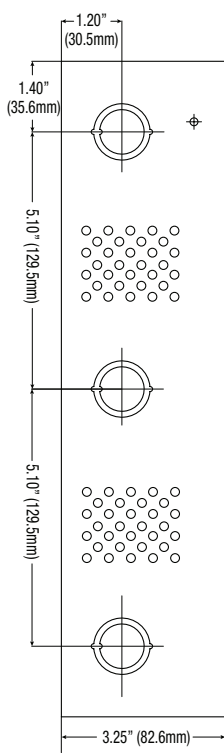
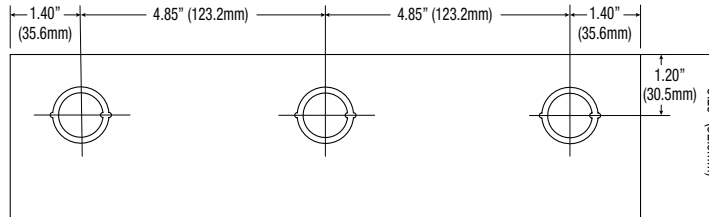

Lifetime Warranty

Altronix Corporation | 140 58th St | Brooklyn, NY 11220 USA

phone: +1 718.567.8181 | fax: +1 718.567.9056 | email: info@altronix.com | www.altronix.com