

# LPS5C24X220

## Linear Power Supply/Charger

Altronix LPS5C24X220 linear power supply/charger converts a 220VAC 50/60Hz input to a 24VDC @ 3.5A continuous supply current. The output stays regulated until the batteries discharge to 25% capacity.

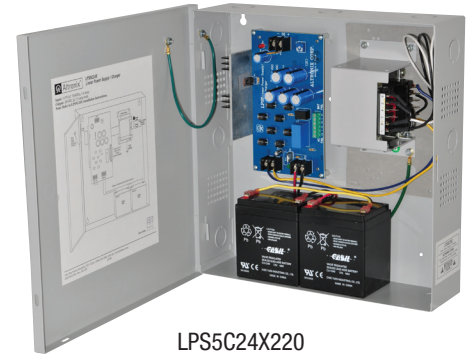

LPS5C24X220

### Specifications

#### Input

Voltage 220VAC (working range 198VAC - 256VAC),  
50/60Hz, 0.8A

#### Outputs

Voltage 24VDC  
Current 3.5A continuous supply current  
Other Short circuit and thermal overload protection  
Filtered and regulated

#### Battery Charging

Capacity 7AH/12VDC (2 within enclosure)  
40AH/65AH (requires separate enclosure)  
Type Sealed lead acid or gel type  
Failover Upon AC loss, instantaneous  
Batteries are sold separately

#### Indicators (LED)

Input Input voltage is present  
DC Output Powered

#### Supervision

AC Failure Form "C" contacts  
Battery Low Form "C" contacts

#### Physical and Environmental

##### Dimensions (H x W x D)

Enclosure:  
13.5" x 13" x 3.25" (342.9mm x 330.2mm x 82.55mm)  
Shipping:  
15" x 13.875" x 4.75" (381mm x 352.4mm x 120.6mm)  
Enclosure accommodates up to two (2) 12VDC/7AH batteries

##### Weight (approx.)

Product: 11.1 lb. (5.03 kg)  
Shipping: 12.4 lb. (5.62 kg)

##### Temperature

Operating: 0°C to 49°C (32°F to 120°F)  
Storage: -20°C to 70°C (-4°F to 158°F)

Relative Humidity 85% +/- 5%

BTU/Hr (approx.) 43 BTU/Hr.

#### Lifetime Warranty

# LPS5C24X220

Linear Power Supply/Charger

## Dimensions and Drawing

Dimensions (H x W x D approximate)

13.5" x 13" x 3.25" (342.9mm x 330.2mm x 82.55mm)

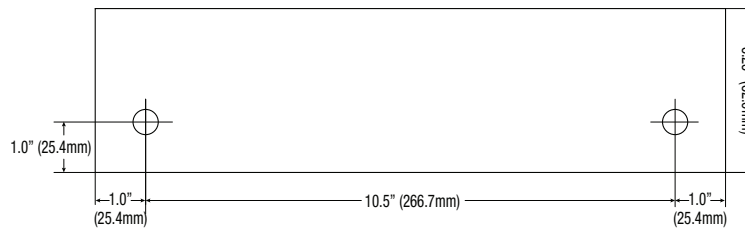
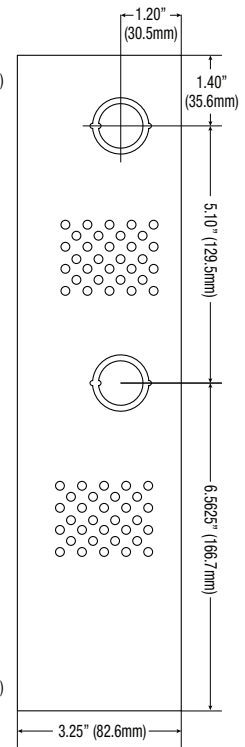
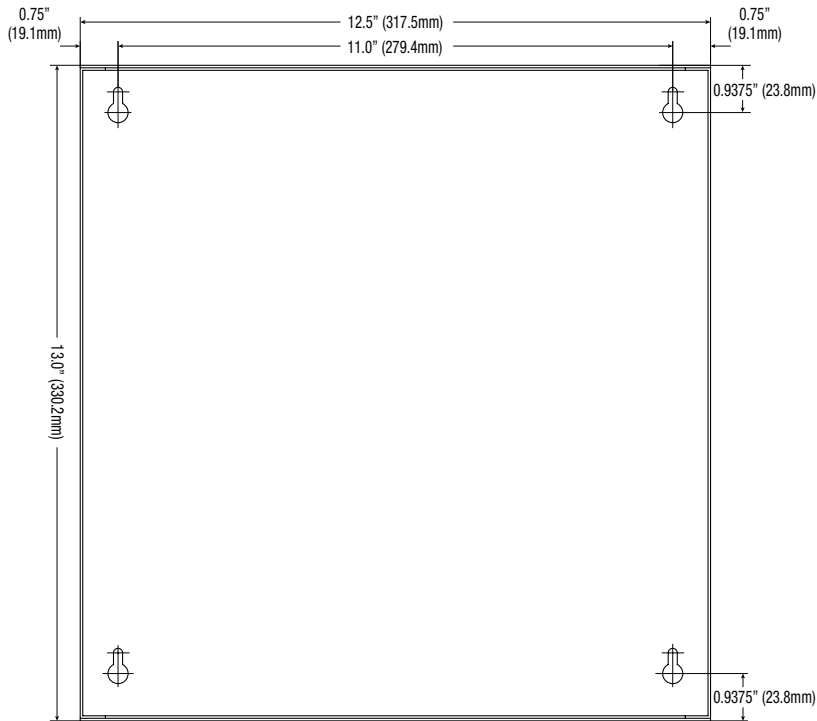
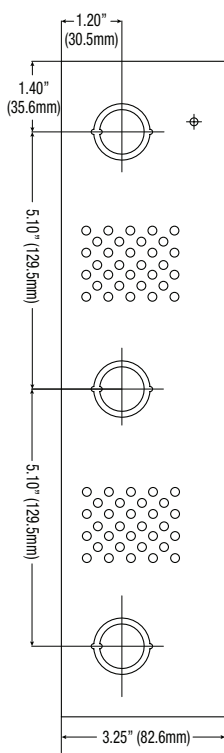
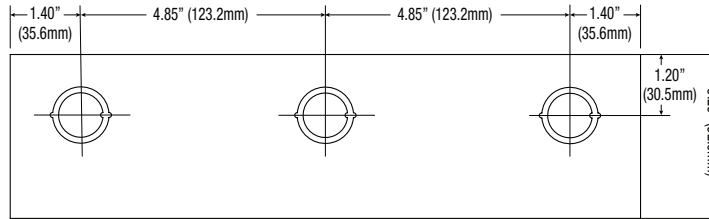

### Lifetime Warranty

Altronix Corporation | 140 58th St | Brooklyn, NY 11220 USA

phone: +1 718.567.8181 | fax: +1 718.567.9056 | email: info@altronix.com | www.altronix.com