

NetWaySP1BTWP

802.3bt Media Converter/Injector with Integral Power

Description

Altronix NetWaySP1BTWP Outdoor 802.3bt media converter/injector provides a single 802.3bt (4PPoE) port up to 90W and accommodates Fiber (1000Base-X/SX/LX) or structured cable to transmit data. Units can be deployed with structured cable, conventional single/multimode fiber or composite cable (fiber + copper combined). Cameras/edge devices may be located up to 100m from the unit.



Key Features

- Single PoE port provides up to 90W for high PoE illuminators, lighting, PTZ cameras, etc.
- Gigabit SFP port.
- 10/100/1000 Mbps data port.
- IEEE 802.3bt (90W), IEEE 802.3at (30W) and IEEE 802.3af (15W) compliant.
- Built-in battery charger
- Lifetime Warranty / Made in the U.S.A.
- NEMA 4/4X, IP66-11 Rated enclosure for outdoor use.

Similar products:

- NetWaySP1BTWPX - Outdoor 802.3bt media converter/injector with integral power in NEMA 4/4X IP66-11 enclosure which accommodates stand-by batteries.
- NetWaySP1BTWPN - Outdoor 802.3bt media converter/injector in compact NEMA 4/4 IP66-11 enclosure (powered via NetWaySP4P with composite cable application)
- NetWaySP1BT - 802.3bt Media converter/injector only

Specifications

Input

115VAC, 60 Hz, 2.5A or 230VAC, 50/60 Hz, 1.3A.
Fusing 5A/250V.

Fiber Port

One (1) 1Gb SFP port.

PoE Port

Single port rated up to 90W max.
IEEE 802.3af, 802.3at and 802.3bt compliant

Data Port

Connectivity: RJ45, auto-crossover.
Wire type: 4-pair CAT5e.
Distance: up to 100m.
Speed: 10/100/1000 Mbps.

Back-up Battery (batteries not included, stored separately)

Type Sealed lead acid or gel type.
Failover Upon AC loss, instantaneous.

Indicators (LED)

Yellow/Green RJ45 LEDs: Yellow: 10/100
Green: 10/100/1000
Green PoE LED: PoE present.
Green SFP (Fiber) LED: SFP connection.

Features

Auto detection and protection of legacy non-PoE cameras/devices.
Lifetime Warranty. Made in U.S.A.

Agency Listings

CE European Conformity.

Physical and Environmental

Enclosure Dimensions (H x W x D approx.):
13.31" x 11.31" x 5.59" (338.1mm x 287.3mm x 142mm).
NEMA 4/4X, IP66-11 Rated enclosure for outdoor use.

Product Weight / Shipping (approx.)

Product Weight: 10.5 lbs. (4.76 kg).
Shipping Weight: 11.9 lbs. (5.4 kg).

Temperature

Operating: 60W: -40°C to 75°C (-40°F to 167°F).
80W: -40°C to 70°C (-40°F to 158°F).
90W: -40°C to 60°C (-40°F to 140°F).

Storage: -40°C to 85°C (-40°F to 185°F).

Relative Humidity: 85% +/-5%

BTU/Hr. (approx.): 61 BTU/Hr.

Operating Altitude: -304.8 to 2,000m.

NetWaySP1BTWP

802.3bt Media Converter/Injector with Integral Power

Typical Application

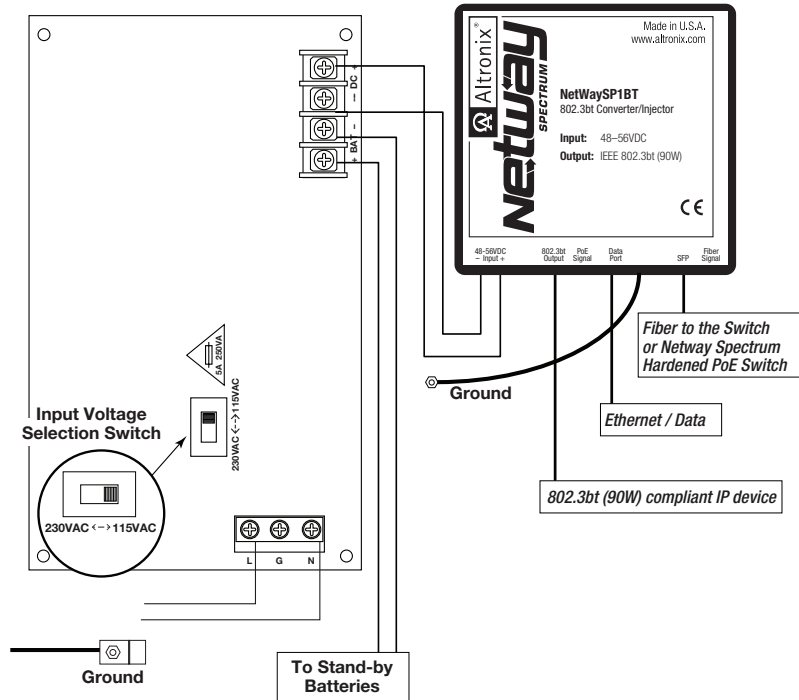

Accessories

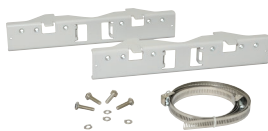

PMK1 - Pole Mount Kit
(order separately)
PMK1 pole mount kit is designed to simplify installation of outdoor units. It accommodates 2" - 8" (diameter) poles.

SFP Modules - Hot pluggable Transceivers

- P1MM** Multi-Mode SFP Module for distances up to 550m.
- P1SM10** Single-Mode SFP Module for distances up to 10km.
- P1AB2K** Single Strand SFP Module for distances up to 2km.
- P1GCE** Copper SFP Module for distances up to 100m.



4-port Ethernet over Fiber Media Converter with Integral power for applications utilizing composite or conventional cabling

NetWaySP4P -

Unit passes a maximum power up to 120W per port from a built-in Power Supply/Charger. Four (4) 1Gb SFP ports.

NetWaySP4P2 -

Unit passes 56VDC power-limited 60W max. per port from a built-in Power Supply/Charger. Four (4) 1Gb SFP ports.