

OLS120D2X

Dual Output Off-Line Switching Power Supply/Charger

Altronix OLS120D2X power supply/charger converts a 115VAC, 50/60Hz or 230VAC, 50/60Hz input to a 12VDC/24VDC output and a 12VDC fixed output (see specifications). This unit has a wide range of applications for access control and security system accessories that require additional power.



OLS120D2X

Specifications

Input

Voltage 115VAC, 60Hz, 0.95A or 230VAC, 50Hz, 0.6A

Outputs

DC1 12 or 24VDC @ 3A

DC2 12VDC @ 1A

Note: If DC2 is not used, DC1 rating is 12VDC or 24VDC rated @ 4A max.

Other Short circuit and thermal overload protection
Filtered and regulated

Battery Charging

Capacity Two (2) 12VDC/7AH batteries within enclosure

Type Sealed lead acid or gel type

Failover Upon AC loss, instantaneous

Batteries are sold separately

Supervision

AC Failure Form "C" contacts

Low Battery Form "C" contacts

Indicators (LED)

Input Input voltage is present

DC Output Powered

Physical and Environmental

Dimensions (H x W x D)

Enclosure: 13.5" x 13" x 3.25"
(342.9mm x 330.2mm x 82.6mm)

Shipping: 15" x 13.875" x 4.75"
(381mm x 352.4mm x 120.6mm)

Enclosure accommodates up to two (2) 12VDC/7AH batteries

Weight (approx.)

Product: 7.4 lb. (3.36 kg)

Shipping: 8.3 lb. (3.76 kg)

Temperature

Operating: 0°C to 49°C (32°F to 120°F)

Storage: -20°C to 70°C (-4°F to 158°F)

Relative Humidity 85% +/- 5%

BTU/Hr (approx.)

12VDC: 25 BTU/Hr.

24VDC: 49 BTU/Hr.

Lifetime Warranty

OLS120D2X

Dual Output Off-Line Switching Power Supply/Charger

Dimensions and Drawing

Dimensions (H x W x D approximate)

13.5" x 13" x 3.25" (342.9mm x 330.2mm x 82.55mm)

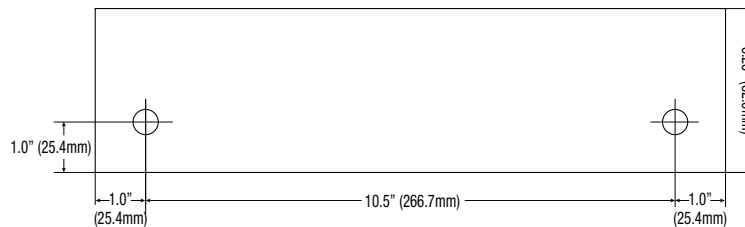
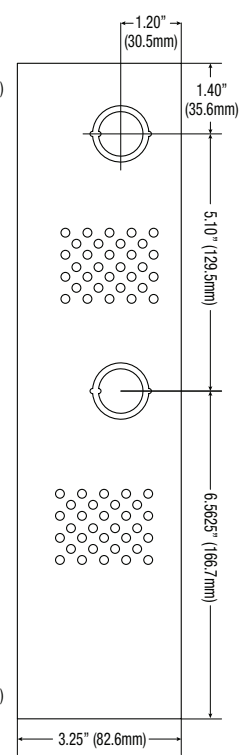
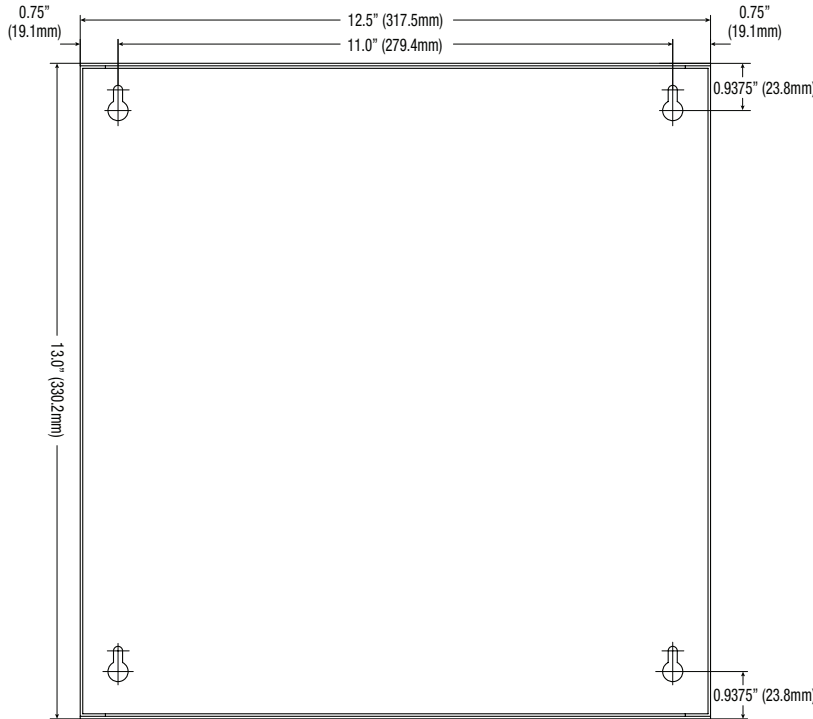
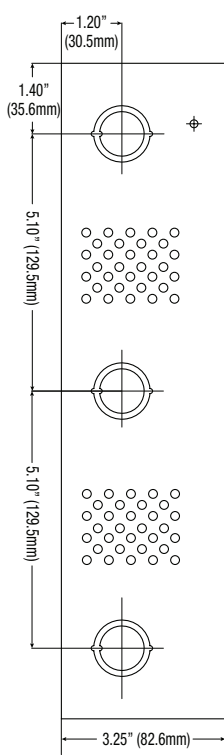
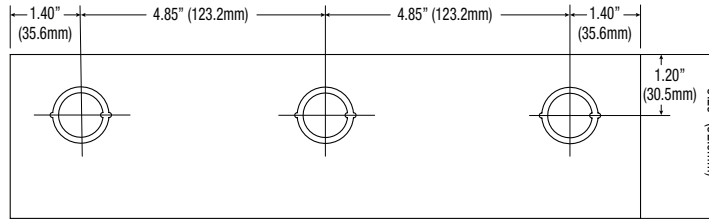

Lifetime Warranty

Altronix Corporation | 140 58th St | Brooklyn, NY 11220 USA

phone: +1 718.567.8181 | fax: +1 718.567.9056 | email: info@altronix.com | www.altronix.com