

## T2M75CK1DQ (Pre-wired Kit)

Access and Power Integration Solution for Mercury



Altronix T2M75CK1DQ is a 14-door access and power integration kit which includes Altronix power and sub-assemblies along with factory installed wire management and wire assemblies that are pre-configured with terminal blocks for Mercury\* hardware. This unit provides ample power and dual voltage outputs to support Mercury platform controllers and locking devices. The T2M75CK1DQ accommodates one (1) Intelligent Dual Reader Controller and seven (7) Dual Reader Interface Modules. Trove Plus simplifies field installations and provides reliable, robust critical power and control for the most demanding applications.

**\*Also compatible with these authentic Mercury partners:**

AccessNsite, Avigilon, BadgePass, BluBox, Feenics, Genetec, Identocard, IMRON, Johnson Controls, Kastle, Keri Systems, LockState, Maxxess, Midpoint Security, NLSS, Open Options, Panasonic i-PRO MonitorCast, Quintron, RS2, S2 Security, Schneider Electric, Vanderbilt



T2M75CK1DQ - includes eFlow102NB, eFlow104NB, (2) LINQ8ACMCB, (2) LINQ8PDCB, wire harnesses and wire magnets

*Mercury modules are sold separately*

### Key Features

- Accommodates the following Mercury controllers:
  - 1 - LP1502 / LP4502 and 7 - MR52
- Convenient knockout configuration:
  - One (1) single knockout - 2" Conduit
  - Sixteen (16) double knockouts - 1/2" Conduit and 3/4" Conduit
- Unit includes:
  - Removable backplane
  - Wire management
  - Custom wire assemblies for power distribution with terminal blocks for controller connections
- Supervision
  - AC Fail
  - Battery Fail and Battery Presence
  - Low power shutdown
- 16 gauge galvanized steel backplane simplifies board layout and wire management
- Enclosure accommodates up to four (4) 12VDC/7AH batteries
- CE European Conformity
- Lifetime Warranty\*

*\*Altronix Power Supply/Chargers and Sub-Assemblies only*

## Specifications

### Power Supply/Charger 1 (eFlow104NB):

<b>Input</b>	
Voltage	120VAC, 60Hz, 4.5A
Input Fuse	6.3A/250V
<b>Output</b>	
Voltage	24VDC @ 10A.
Auxiliary	1A (unswitched)
Protection	Overvoltage protection. Filtered and regulated

### Power Supply/Charger 2 (eFlow102NB):

<b>Input</b>	
Voltage	120VAC, 60Hz, 3.5A
Input Fuse	5A/250V
<b>Output</b>	
Voltage	12VDC @ 10A
Auxiliary	1A (unswitched).
Protection	Overvoltage protection. Filtered and regulated

### Both Power Supplies:

<b>Battery Charging</b>	
Capacity	12VDC/7AH (4 within enclosure) 40AH/65AH (requires separate enclosure)
Type	Sealed lead acid or gel type
Failover	Upon AC loss, instantaneous
Batteries are sold separately	

### Fire Alarm Disconnect

Supervised	Latching or non-latching
EOL	10K Resistor

### Supervision

AC Failure	Form "C" contacts
Battery	Form "C" contacts
<b>Low DC Power Shutdown</b>	
Shuts down DC output terminals if battery voltage drops below 71-73% for 12V units and 70-75% for 24V units (depending on the power supply). Prevents deep battery discharge	

### Indicators (LED)

AC Input	120VAC is present
DC Output	Powered
Battery	Discharged or not connected

### Two (2) Network Power Distribution Modules (LINQ8PDCB):

<b>Input</b>	
Voltage	12VDC from eFlow102NB
Input Fuses	15A/32V

### Outputs

PTC protected auto-resettable outputs	
Any of the eight (8) PTC protected power outputs are selectable to follow power Input 1 or Input 2	
Individual outputs may be set to OFF position for servicing	
Output PTCs:	2.5A

### Status Monitoring

Power Supply output voltage and load, Voltage and load of each output	
FACP trigger and reset status, Unit temperature (Celsius)	
Power Supply AC and Battery status, Battery health	

### Reporting:

Windows Dashboard Alert messages	
E-mail notifications, Event Log tracks history	

### Indicators (LED)

Bat Local	Charging current status
FACP	Triggered / Released
Input	Input signal
Out1 - Out8	Output status

### Two (2) Network Access Power Controllers (LINQ8ACMCB):

<b>Input</b>	
Voltage	24VDC from eFlow104NB
Input PTCs	9A

### Outputs

PTC protected auto-resettable outputs	
Any of the eight (8) PTC protected power outputs are selectable to follow power Input 1 or Input 2	
Individual outputs may be set to OFF position for servicing	
Output PTCs:	2.5A

### Programming Features:

#### Eight (8) Programmable Outputs:

- Fail-safe, fail-secure or auxiliary outputs
- Input controlled or manually controlled through software
- High (over) and low (under) voltage and current monitoring by output
- Multiple outputs may be programmed to be triggered by a single input
- Battery back-up by output

#### Eight (8) Programmable Trigger Inputs:

- Normally open (NO), Normally closed (NC) or Open collector sink inputs
- Wet Input (5VDC - 24VDC) with 10k resistor
- Any combination of the above

#### Other Programmable Trigger Inputs:

- Monitor power supply(ies) input for voltage and current limits (high/low)
- Input and output current calibration, Programmable timer events
- Programmable user levels, Enable or disable alerts by type
- Programmable alert reporting delay

### Indicators (LED)

<b>Green AC LED:</b>	indicates AC trouble condition
<b>Green BAT LED:</b>	indicates battery trouble condition
<b>Green FACP LED:</b>	indicates FACP disconnect is triggered
<b>Flashing Blue Heartbeat LED:</b>	indicates network connection
<b>Individual OUT1 - OUT8 LEDs:</b>	indicate outputs are triggered
<b>Individual Voltage LEDs:</b>	indicate 12VDC (Green) or 24VDC (Red)

### T2M75CK1DQ Kit:

#### Agency Listings

CE	European Conformity
----	---------------------

#### Physical and Environmental

<b>Dimensions (H x W x D)</b>	
Enclosure:	27.25" x 21.5" x 6.5" (692.2mm x 546.1mm x 165.1mm)
Shipping:	32.5" x 26.5" x 11.125" (825.5mm x 673.1mm x 282.6mm)
<b>Weight (approx.)</b>	
Product	85.6 lb. (38.83 kg)
Shipping	98.8 lb. (44.82 kg)
<b>Temperature</b>	
Operating	0°C to 49°C (32°F to 120°F)
Storage	- 20°C to 70°C (- 4°F to 158°F)
<b>Relative Humidity</b>	85% +/- 5%
<b>BTU/Hr (approx.):</b>	221 BTU/Hr.

**T2M75CK1DQ** (Pre-wired Kit)  
 Access and Power Integration Solution for Mercury

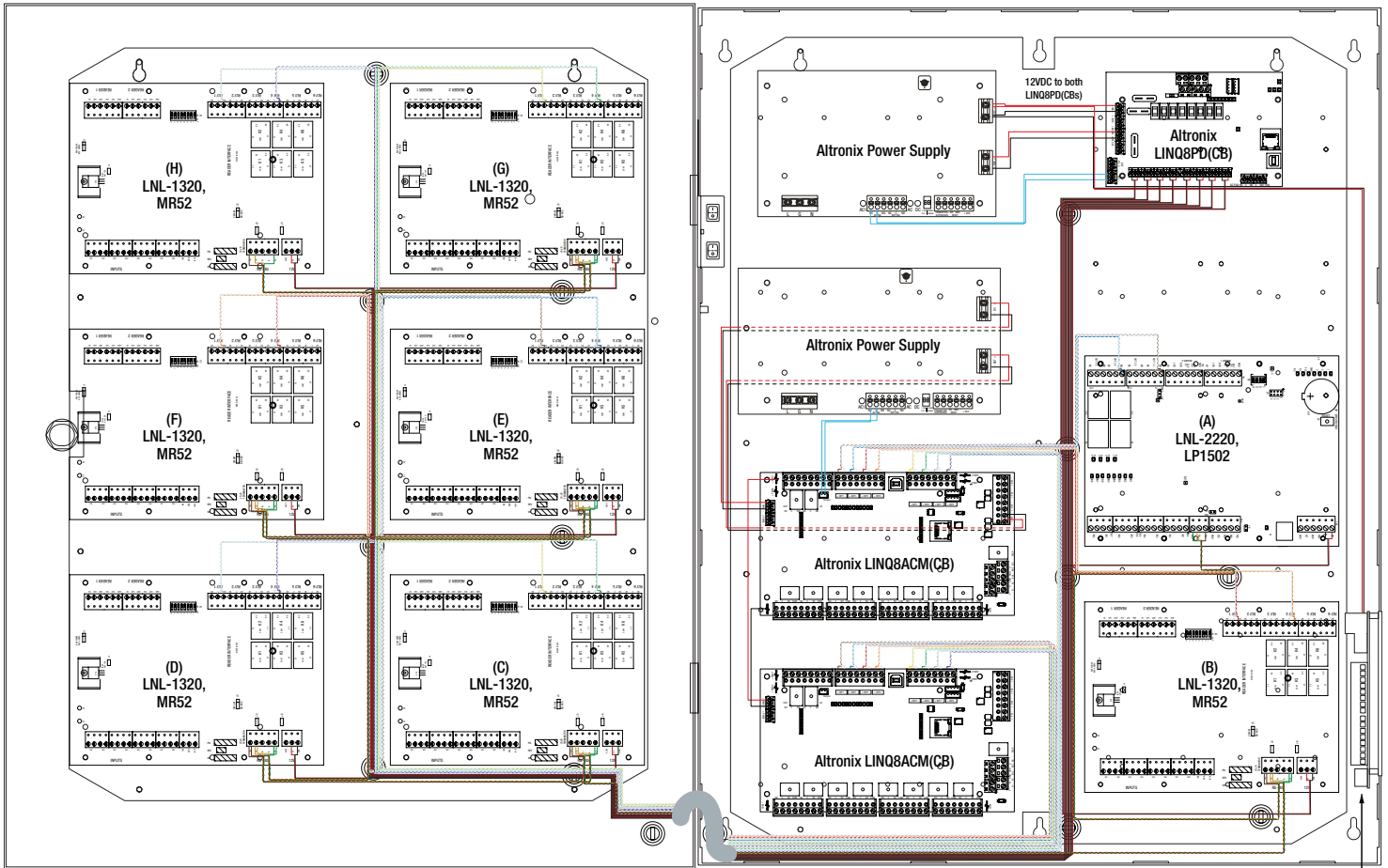

Altronix  
 LINQ8PD(CB)  
 is mounted  
 on the side of  
 the enclosure  
 using BR1 bracket

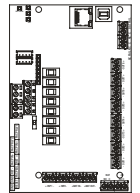

**Accessories** (order separately) —————



WM5

**WM5, WM25, WM100 - Magnetic Cable Tie Mounts**

Altronix WM5, WM25, and WM100 are packs of 5, 25 or 100 magnetic cable tie mounts respectively. They accommodate standard zip ties or velcro straps. These are ideal for wire management in our Trove series.



Mounting Magnet

**MM4, MM8, MM12, MM24 - Magnetic Mounting Solution**

Altronix mounting magnets accommodate screws and nylon standoffs to allow for mounting various boards/ accessories in any metal enclosure or backplane.



BR1

**BR1 - Sub-Assembly Mounting Bracket**

Altronix BR1 mounting bracket is compatible with Altronix Maximal and Trove enclosures. It allows to mount one (1) PD4UL(CB), PD8UL(CB), ACM4(CB), MOM5, VR6, PDS8, NetWay5B or LINQ8PD(CB) sub-assembly on the enclosure's inside wall, saving valuable space.

Trove2BWC  
with  
batteries



Trove2BWC  
with  
wires



**TROVE2BWC - Battery/Wire Trough Enclosure**

Altronix Trove2BWC is a dual-purpose enclosure that can be used as wiring trough or battery cabinet when mounted above or below of the Trove2 integrated power and access solution. The knockouts on the Trove2BWC have been strategically placed to line up with the Trove2 allowing for easy conduit connections between cabinets. Trove2BWC includes cam locks and 2 tamper switches to ensure access to wiring and batteries is secure.

**Dimensions and Drawing**

Dimensions (H x W x D approximate)  
 27.25" x 21.5" x 6.5" (692.2mm x 546.1mm x 165.1mm)

