

## T2M75LCK1D (Pre-wired Kit)

Access and Power Integration Solution for Mercury



Altronix T2M75LCK1D is a 14-door access and power integration kit which includes Altronix power and sub-assemblies along with factory installed wire management and wire assemblies that are pre-configured with terminal blocks for Mercury\* hardware. This unit provides ample power and dual voltage outputs to support Mercury platform controllers and locking devices. The T2M75LCK1D accommodates one (1) Intelligent Dual Reader Controller and seven (7) Dual Reader Interface Modules. Trove Plus simplifies field installations and provides reliable, robust critical power and control for the most demanding applications.

**\*Also compatible with these authentic Mercury partners:**

AccessNsite, Avigilon, BadgePass, BluBox, Feenics, Genetec, Identocard, IMRON, Johnson Controls, Kastle, Keri Systems, LockState, Maxxess, Midpoint Security, NLSS, Open Options, Panasonic i-PRO MonitorCast, Quintron, RS2, S2 Security, Schneider Electric, Vanderbilt



T2M75LCK1D - includes AL1012ULXB, AL1024ULXB2, ACMS8CB, VR6, PDS8CB, wire harnesses and wire magnets

*Mercury modules are sold separately*

### Key Features

- Accommodates the following Mercury controllers:
  - 1 - LP1502 / LP4502 and 7 - MR52
- Convenient knockout configuration:
  - One (1) single knockout - 2" Conduit
  - Sixteen (16) double knockouts - 1/2" Conduit and 3/4" Conduit
- Unit includes:
  - Removable backplane
  - Wire management
  - Custom wire assemblies for power distribution with terminal blocks for controller connections
- 16 gauge galvanized steel backplane simplifies board layout and wire management
- Supervision
  - AC Fail
  - Battery Fail and Battery Presence
- Agency Listings:
  - All Altronix components of this Trove kit are UL Listed sub-assemblies. Please refer to the Sub-Assembly Installation Guides for further information
  - UL: UL294 - Access Control System
  - cUL: CAN/ULC - s319-05 - Electronic Access Control Systems
  - CE European Conformity
- Enclosure accommodates up to four (4) 12VDC/7AH batteries
- Lifetime Warranty\*

*\*Altronix Power Supply/Chargers and Sub-Assemblies only*

**Specifications**

**Power Supply 1 (AL1012ULXB):**

<b>Input</b>	
Voltage	115VAC 60Hz, 2.6A max.
Input Fuse	5A/250V
<b>Output</b>	
Voltage	12VDC
Current	10A @ 24VDC continuous max.

**Power Supply 2 (AL1024ULXB2):**

<b>Input</b>	
Voltage	115VAC 60Hz, 4.2A max.
Input Fuse	5A/250V
<b>Output</b>	
Voltage	24VDC
Current	10A @ 24VDC continuous max.

**Both Power Supplies:**

Overvoltage protection. Filtered and regulated outputs

**Back-up Battery**

Capacity	7AH /12VDC (4 within enclosure) 40AH/65AH (requires separate enclosure)
Type	Sealed lead acid or gel type
Failover	Upon AC loss, instantaneous

**Supervision**

AC Failure	Form "C" contacts
Battery	Form "C" contacts

**Indicators (LED)**

Input	115VAC is present
DC Output	Powered
Battery	Discharged or not connected

**Two (2) Dual Input Access Power Controllers (ACMS8CB):**

<b>Input</b>	
Voltage	24VDC from AL1024ULXB2 and 12VDC from VR6
Input PTCs	9A

**Outputs**

Voltage 12 or 24VDC individually selectable  
 Eight (8) selectable 12VDC - 24VDC independently controlled outputs or eight (8) independently controlled Form "C" relay outputs:  
 a) Fail-Safe and/or Fail-Secure power outputs  
 b) Form "C" Relays. 28VAC or VDC @ 2.5A Rated  
 c) Auxiliary power outputs (unswitched)  
 d) Any combination of the above

Any of the eight (8) PTC protected power outputs are selectable to follow power Input 1 or Input 2

Individual outputs may be set to OFF position for servicing  
 Output PTCs 2.5A

**Indicators (LED)**

Red LEDs	Outputs are triggered (relays energized)
Blue LED	FACP disconnect is triggered
<b>Individual voltage LEDs:</b>	
Green:	12VDC
Red:	24VDC

**Voltage Regulator (VR6):**

<b>Input</b>	
Voltage	24VDC from AL1024ULXB2
<b>Output</b>	
Voltage	12VDC
Current	6A continuous
Other	Surge suppression

**Indicators (LED)**

Input	24VDC is present
Output	Powered

**Dual Input Power Distribution Module (PDS8CB):**

<b>Input</b>	
Voltage	12VDC from AL1012ULXB
Input PTCs	9A

**Outputs**

Voltage 12VDC and/or 24VDC  
 Any of the eight (8) power outputs are selectable to follow power Input 1 or Input 2  
 Individual outputs may be set to OFF position for servicing  
 Output PTCs 2.5A

**Indicators (LED)**

DC Output	Eight (8) individual output LEDs
Green:	12VDC
Red:	24VDC

**T2M75LCK1D Kit:**

**Agency Listings**

CE European Conformity  
 All components of this Trove kit are UL Listed sub-assemblies  
 Please refer to the corresponding Sub-Assembly Installation Guides for further information

**Physical and Environmental:**

**Dimensions (H x W x D)**  
 Enclosure: 27.25" x 21.5" x 6.5" (692.2mm x 546.1mm x 165.1mm)  
 Shipping: 32.5" x 26.5" x 11.125" (825.5mm x 673.1mm x 282.6mm)

**Weight (approx.)**

Product:	49.6 lb. (22.5 kg)
Shipping:	52.6 lb. (23.9 kg)

**Temperature**

Operating	0°C to 49°C (32°F to 120°F)
Storage	- 20°C to 70°C (- 4°F to 158°F)

**Relative Humidity**

85% +/- 5%

BTU/Hr. (approx.): 206 BTU/Hr.

**T2M75LCK1D** (Pre-wired Kit)  
 Access and Power Integration Solution for Mercury

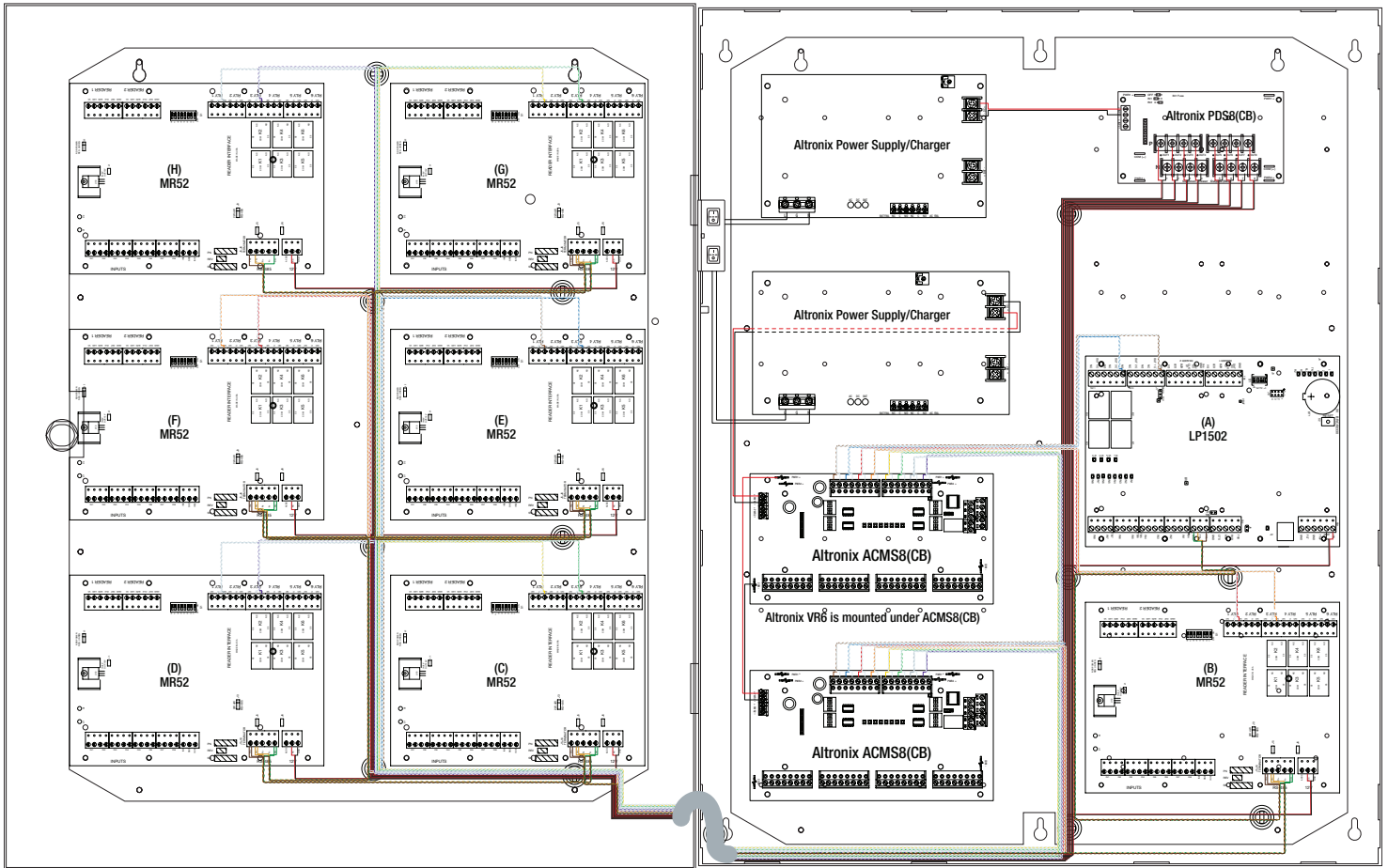

**Accessories** (order separately)



WM5

**WM5, WM25, WM100 - Magnetic Cable Tie Mounts**

Altronix WM5, WM25, and WM100 are packs of 5, 25 or 100 magnetic cable tie mounts respectively. They accommodate standard zip ties or velcro straps. These are ideal for wire management in our Trove series.



Mounting Magnet

**MM4, MM8, MM12, MM24 - Magnetic Mounting Solution**

Altronix mounting magnets accommodate screws and nylon standoffs to allow for mounting various boards/ accessories in any metal enclosure or backplane.



BR1

**BR1 - Sub-Assembly Mounting Bracket**

Altronix BR1 mounting bracket is compatible with Altronix Maximal and Trove enclosures. It allows to mount one (1) PD4UL(CB), PD8UL(CB), ACM4(CB), MOM5, VR6, PDS8, NetWay5B or LINQ8PD(CB) sub-assembly on the enclosure's inside wall, saving valuable space.

Trove2BWC  
with  
batteries



Trove2BWC  
with  
wires



**TROVE2BWC - Battery/Wire Trough Enclosure**

Altronix Trove2BWC is a dual-purpose enclosure that can be used as wiring trough or battery cabinet when mounted above or below of the Trove2 integrated power and access solution. The knockouts on the Trove2BWC have been strategically placed to line up with the Trove2 allowing for easy conduit connections between cabinets. Trove2BWC includes cam locks and 2 tamper switches to ensure access to wiring and batteries is secure.

**Dimensions and Drawing**

Dimensions (H x W x D approximate)  
 27.25" x 21.5" x 6.5" (692.2mm x 546.1mm x 165.1mm)

