

# eFlow102NV Series

## Power Supply/Chargers

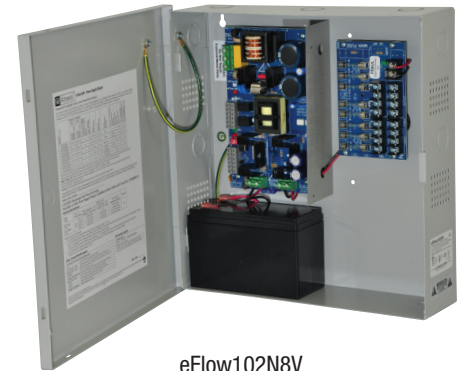

Altronix eFlow102NV series power supply/chargers convert a 220VAC (working range 198VAC - 256VAC), 50/60Hz input into a single fused, eight (8) or sixteen (16) fuse/PTC protected 12VDC outputs with a total of 10A max. They also offer a suite of features that includes fire alarm disconnect, overvoltage protection, and low power disconnect which prevents deep discharge of stand-by batteries.



eFlow102N8V

### Key Features

- Available with 1, 8 or 16 outputs
- Fused or PTC protected outputs
- Additional Aux. Output rated @ 1A
- Overvoltage protection
- Fire alarm disconnect
- Supervision
  - AC Fail
  - Battery Fail and Battery Presence
  - Low power shutdown
- Built-in charger for sealed lead acid or gel type batteries
- Instantaneous transfer to stand-by batteries
- Short circuit and overload protection
- AC input and DC output LED indicators
- CE European Conformity
- Lifetime Warranty

### eFlow102NV Series Power Supply Configuration Reference Chart

Altronix Model Number	Input Rating: 220VAC, 50/60Hz	Input Fuse Rating	Battery Fuse Rating	Nominal DC Outputs		Maximum Supply Current for Main and Aux. Outputs (A)	Ripple Voltage (mV) Under low battery condition	Power Distribution Module	Number of Outputs	Fused Outputs Ratings	Auto-Resettable PTC Outputs Ratings	Accommodates up to 7AH Batteries	Accommodates up to 12AH Batteries
				[DC]	[AUX]								
eFlow102NV	2.1A	5A/250V	15A/32V	10.03-	10.03-	10A	760	N/A	1	-	-	✓	-
eFlow102NXV				13.2	13.2					-	-	✓	
eFlow102N8V	2.1A	5A/250V	15A/32V	10.03-	10.03-	10A	760	PD8	8	2.5A	-	✓	-
eFlow102NX8V				13.2	13.2					2.5A	-	✓	
eFlow102N8DV	2.1A	5A/250V	15A/32V	9.78-	10.03-	10A	760	PD8CB	8	-	2A	✓	-
eFlow102NX8DV				13.2	3.2					-	2A	✓	
eFlow102N16V	2.1A	5A/250V	15A/32V	10.03-	10.03-	10A	760	PD16W	16	2.5A	-	✓	-
eFlow102NX16V				13.2	13.2			2 - PD8		2.5A	-	✓	
eFlow102N16DV	2.1A	5A/250V	15A/32V	9.78-	10.03-	10A	760	PD16WCB	16	-	2A	✓	-
eFlow102NX16DV				13.2	13.2			2 - PD8CB		-	2A	✓	

#### Lifetime Warranty

## Specifications

### Input

Voltage 220VAC (working range 198VAC - 256VAC),  
50/60Hz, 2.1A max.  
Fusing 5A/250V

### Outputs

Voltage 12VDC  
Current 10A continuous max.  
Protection Fused 2.5A / PTC 2A  
Auxiliary 1A (unswitched)  
Other Overvoltage protection. Filtered and regulated

### Battery Charging

Capacity 7AH/12VDC (1 or 2 within enclosure)  
12AH/12VDC (requires larger "X" enclosure)  
40AH/65AH (requires separate enclosure)  
Type Sealed lead acid or gel type  
Fuse Rating 15A/32V  
Failover Upon AC loss, instantaneous  
Batteries are sold separately

### Fire Alarm Disconnect

Supervised Latching or non-latching  
EOL 10K Resistor

### Supervision

AC Failure Form "C" contacts  
Battery Form "C" contacts

### Low DC Power Shutdown

Shuts down DC output terminals if battery voltage drops  
below 71-73% for 12V units (depending on the power supply)  
Prevents deep battery discharge

### Indicators (LED)

Input 220VAC is present  
DC Output Powered

### Agency Listings

CE European Conformity

### Physical and Environmental

#### Dimensions (H x W x D)

#### eFlow102NV, eFlow102N8(D)V, eFlow102N16(D)V:

Enclosure: 13.5" x 13" x 3.25" (342.9mm x 330.2mm x 82.55mm)  
Shipping: 15" x 13.875" x 4.75" (381mm x 352.4mm x 120.6mm)

#### eFlow102NXV, eFlow102NX8(D)V, eFlow102NX16(D)V:

Enclosure: 15.5" x 12" x 4.5" (393.7mm x 304.8mm x 114.3mm)  
Shipping: 16.5" x 13.5" x 6" (419.1mm x 342.9mm x 152.5mm)

#### Weight (approx.)

Model	Product Weight	Shipping Weight
eFlow102NV	6.55 lb. (2.97 kg)	7.45 lb. (3.38 kg)
eFlow102NXV	8.4 lb. (3.81 kg)	9.5 lb. (4.31 kg)
eFlow102N8(D)V	6.7 lb. (3.04 kg)	7.6 lb. (3.45 kg)
eFlow102NX8(D)V	8.6 lb. (3.9 kg)	9.7 lb. (4.4 kg)
eFlow102N16(D)V	6.85 lb. (3.11 kg)	7.75 lb. (3.52 kg)
eFlow102NX16(D)V	8.75 lb. (3.97 kg)	9.85 lb. (4.47 kg)

#### Temperature

Operating: 0°C to 49°C (32°F to 120°F)  
Storage: -20°C to 70°C (-4°F to 158°F)

#### Relative Humidity

85% +/- 5%

#### BTU/Hr (approx.)

61 BTU/Hr.

## Accessories (order separately)

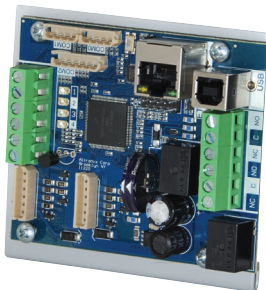

LINQ2

### LINQ2 - Network Supervision

Altronix LINQ2 Network Communication Module provides remote supervision, control and monitoring over LAN/WAN

- Remotely reports accurate power diagnostics
- Controls power and resets devices
- Reports system diagnostics via Email



### Lifetime Warranty

Altronix Corporation | 140 58th St | Brooklyn, NY 11220 USA

phone: +1 718.567.8181 | fax: +1 718.567.9056 | email: info@altronix.com | www.altronix.com

## Dimensions and Drawing

eFlow102NV, eFlow102N8(D)V, eFlow102N16(D)V Dimensions (H x W x D approximate)  
 13.5" x 13" x 3.25" (342.9mm x 330.2mm x 82.55mm)

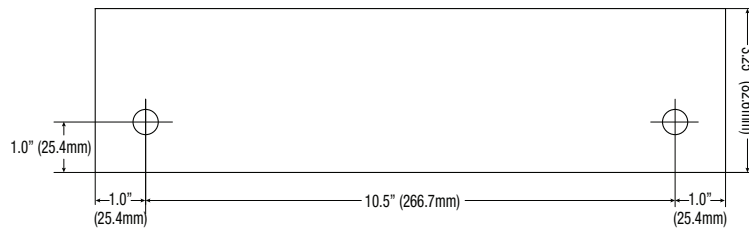
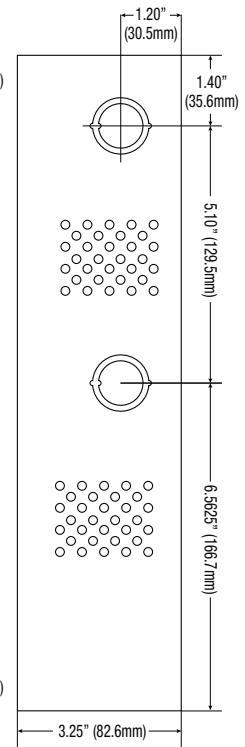
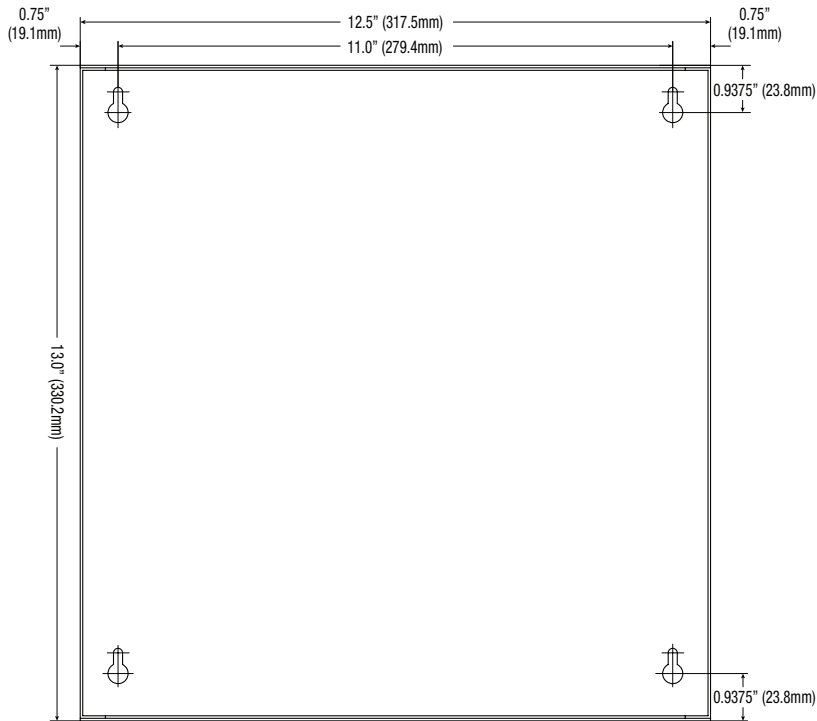
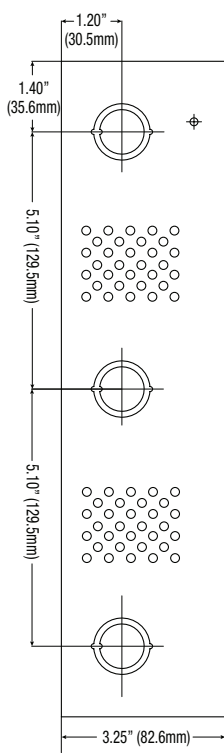
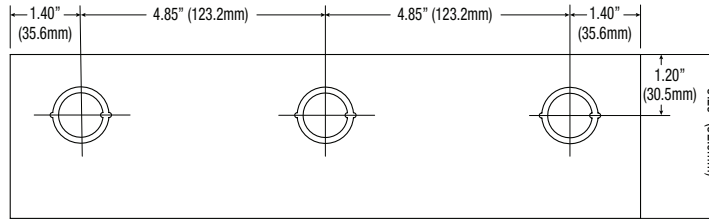

### Lifetime Warranty

## Dimensions and Drawing

eFlow102NXV, eFlow102NX8(D)V, eFlow102NX16(D)V Dimensions (H x W x D approximate)  
 15.5" x 12" x 4.5" (393.7mm x 304.8mm x 114.3mm)

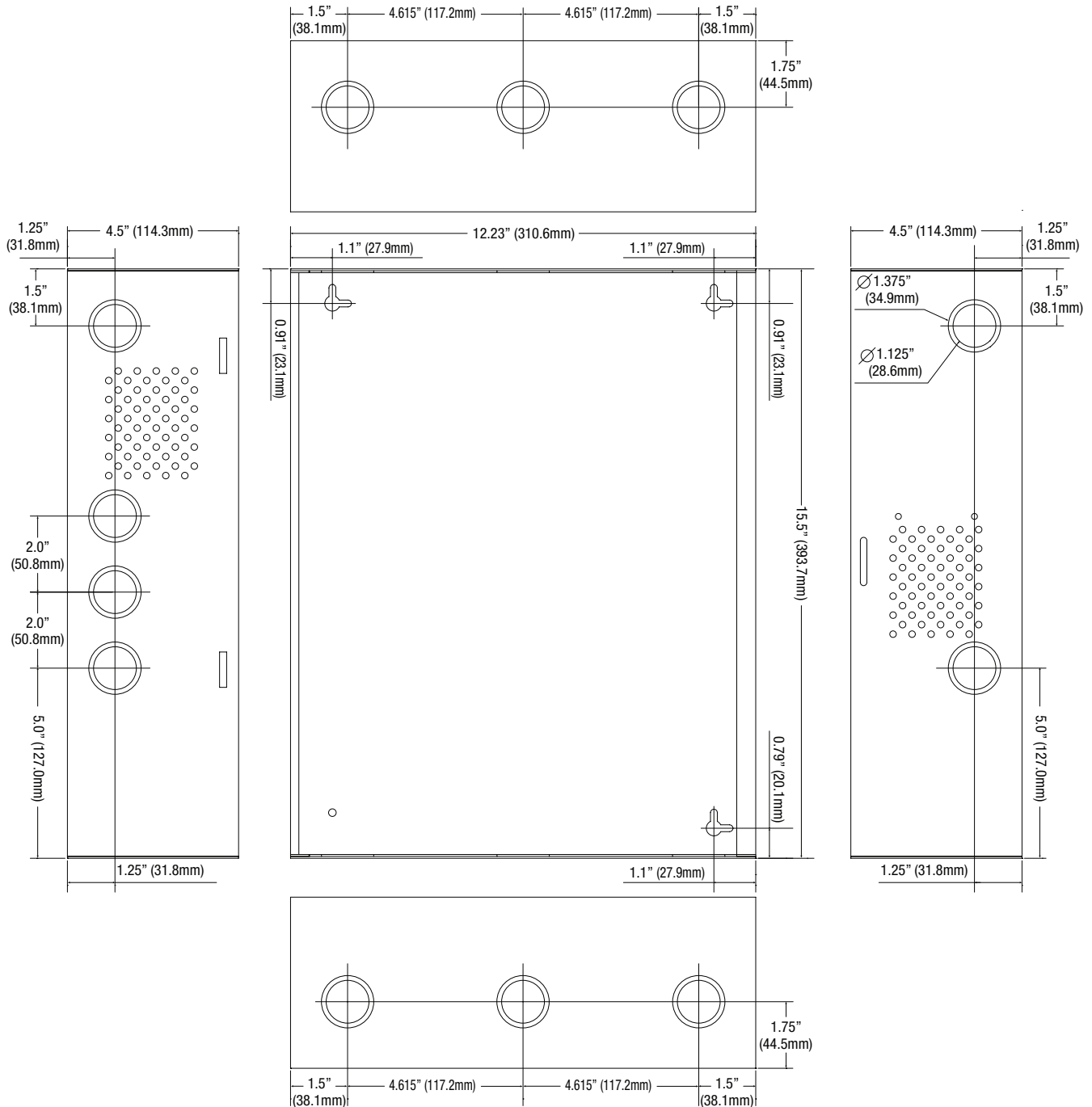

### Lifetime Warranty