

eFlow104N Series

Power Supply/Chargers



Altronix eFlow104N series power supply/chargers convert a 120VAC, 60Hz input into a single, eight (8), or sixteen (16) fused outputs or PTC protected Class 2 power-limited 24VDC outputs with a total of 10A max. They also offer a suite of features that includes fire alarm disconnect, overvoltage protection, and low power disconnect which prevents deep discharge of stand-by batteries.



eFlow104N8

Key Features

- Available with 1, 8 or 16 outputs
- Fused outputs or PTC protected Class 2 power-limited outputs
- Additional aux. Class 2 power-limited output rated @ 1A
- Overvoltage protection
- Fire alarm disconnect
- Supervision
 - AC Fail
 - Battery Fail and Battery Presence
 - Low power shutdown
- Built-in charger for sealed lead acid or gel type batteries
- Instantaneous transfer to stand-by batteries
- Short circuit and overload protection
- AC input and DC output LED indicators
- UL Listed in the U.S. and Canada
- CE European Conformity
- Lifetime Warranty

eFlow104N series Power Supply Configuration Reference Chart

Altronix Model Number	Input Rating: 120VAC, 60Hz	Input Fuse Rating	Battery Fuse Rating	Nominal DC Outputs		Maximum Supply Current for Main and Aux. Outputs (A)	Ripple Voltage (mV) Under low battery condition	Power Distribution Module	Number of Outputs	Fused Outputs Ratings	Avot-Resetttable PTC Outputs Ratings	Accommodates up to 7AH Batteries	Accommodates up to 12AH Batteries
				[DC] 24VDC Output Range (V)	[AUX] 24VDC Output Range (V)								
eFlow104N	4.5A	6.3A/250V	15A/32V	20.17-	20.28-	10A	700	N/A	1	-	-	✓	-
eFlow104NX				26.4	26.4					-	-	-	✓
eFlow104N8	4.5A	6.3A/250V	15A/32V	20.17-	20.28-	10A	700	PD8UL	8	2.5A	-	✓	-
eFlow104NX8				26.4	26.4					2.5A	-	-	✓
eFlow104N8D	4.5A	6.3A/250V	15A/32V	20.0-	20.28-	10A	700	PD8ULCB	8	-	2A	✓	-
eFlow104NX8D				26.4	26.4					-	2A	-	✓
eFlow104N16	4.5A	6.3A/250V	15A/32V	20.17-	20.28-	10A	700	PD16W	16	2.5A	-	✓	-
eFlow104NX16				26.4	26.4			2 - PD8UL		2.5A	-	-	✓
eFlow104N16D	4.5A	6.3A/250V	15A/32V	20.0-	20.28-	10A	700	PD16WCB	16	-	2A	✓	-
eFlow104NX16D				26.4	26.4			2 - PD8ULCB		-	2A	-	✓

Lifetime Warranty

Specifications

Input

Voltage 120VAC, 60Hz, 4.5A max.
Input Fuse 6.3A/250V

Outputs

Voltage 24VDC
Current 10A continuous max.
Protection Fused 2.5A / PTC 2A
Auxiliary Class 2 power-limited @ 1A (unswitched)
Other Overvoltage protection. Filtered and regulated

Battery Charging

Capacity 7AH/12VDC (2 within enclosure)
12AH/12VDC (requires larger "X" enclosure)
40AH/65AH (requires separate enclosure)
Type Sealed lead acid or gel type
Fuse Rating 15A/32V
Failover Upon AC loss, instantaneous
Batteries are sold separately

Fire Alarm Disconnect

Supervised Latching or non-latching
EOL 10K Resistor

Supervision

AC Failure Form "C" contacts
Battery Form "C" contacts

Low DC Power Shutdown

Shuts down DC output terminals if battery voltage drops below 70-75% for 24V units (depending on the power supply)
Prevents deep battery discharge

Indicators (LED)

Input 120VAC is present
DC Output Powered

Agency Listings

UL:
UL294 Access Control System Units
UL603 Power Supplies for Use with Burglar-Alarms Systems
UL1481 Power Supplies for Fire Protective Signaling Systems
cUL:
ULC-S318-96 Power Supplies for Burglar Alarm Systems Also suitable for Access Control
CSFM California State Fire Marshall Approved
CE European Conformity

Physical and Environmental

Dimensions (H x W x D)

eFlow104N, eFlow104N8(D), eFlow104N16(D):

Enclosure: 13.5" x 13" x 3.25" (342.9mm x 330.2mm x 82.55mm)
Shipping: 15" x 13.875" x 4.75" (381mm x 352.4mm x 120.6mm)

eFlow104NX, eFlow104NX8(D), eFlow104NX16(D):

Enclosure: 15.5" x 12" x 4.5" (393.7mm x 304.8mm x 114.3mm)
Shipping: 16.5" x 13.5" x 6" (419.1mm x 342.9mm x 152.5mm)

Weight (approx.)

Model	Product Weight	Shipping Weight
eFlow104NV	6.8 lb. (3.08 kg)	7.7 lb. (3.49 kg)
eFlow104NXV	8.65 lb. (3.92 kg)	9.75 lb. (4.42 kg)
eFlow104N8(D)V	6.95 lb. (3.15 kg)	7.85 lb. (3.56 kg)
eFlow104NX8(D)V	8.8 lb. (3.99 kg)	9.9 lb. (4.49 kg)
eFlow104N16(D)V	7.1 lb. (3.22 kg)	8 lb. (3.63 kg)
eFlow104NX16(D)V	8.95 lb. (4.06 kg)	10.05 lb. (4.56 kg)

Temperature

Operating: 0°C to 49°C (32°F to 120°F)
Storage: -20°C to 70°C (-4°F to 158°F)

Relative Humidity 85% +/- 5%

BTU/Hr (approx.) 123 BTU/Hr.

Accessories (order separately)

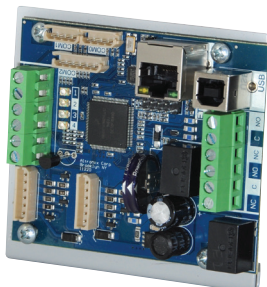

LINQ2

LINQ2 - Network Supervision

Altronix LINQ2 Network Communication Module provides remote supervision, control and monitoring over LAN/WAN

- Remotely reports accurate power diagnostics
- Controls power and resets devices
- Reports system diagnostics via Email



Lifetime Warranty

Dimensions and Drawing

eFlow104N, eFlow104N8(D), eFlow104N16(D) Dimensions (H x W x D approximate)
 13.5" x 13" x 3.25" (342.9mm x 330.2mm x 82.55mm)

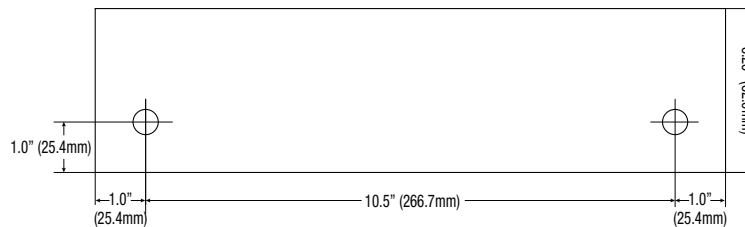
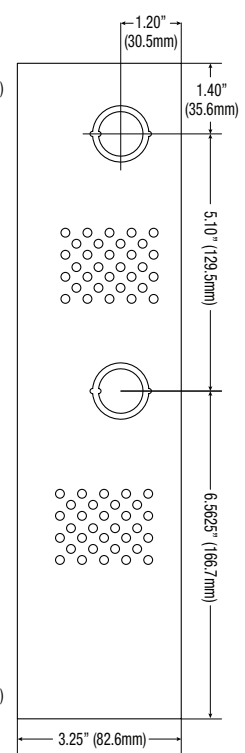
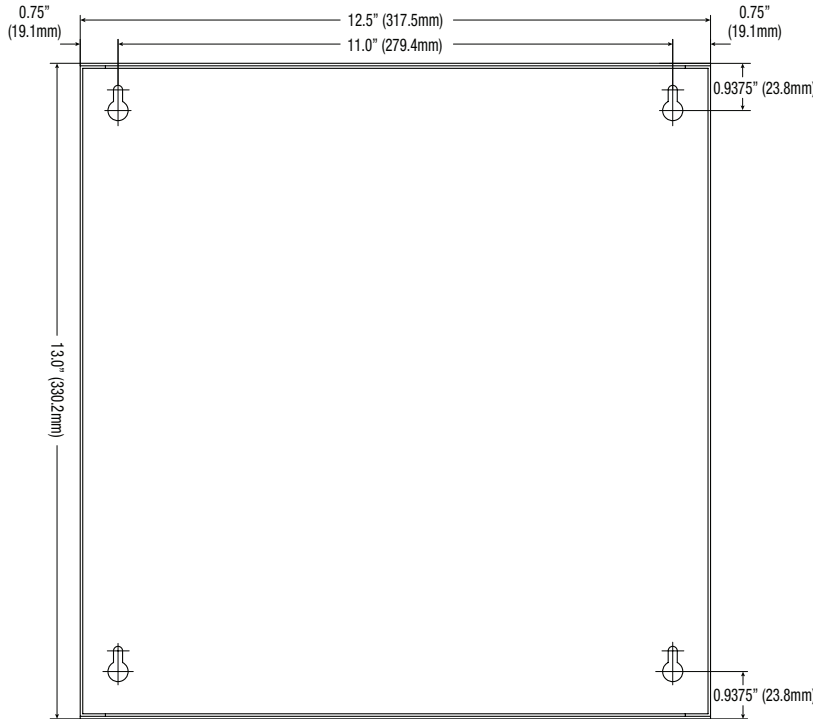
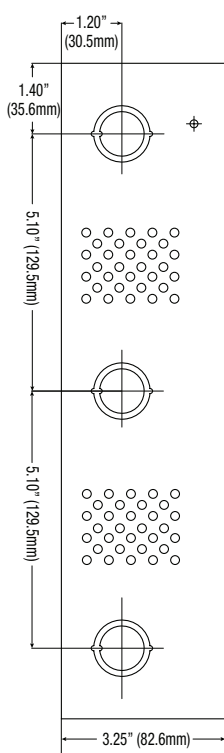
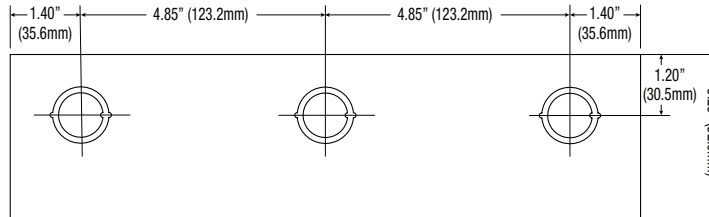

Lifetime Warranty

Dimensions and Drawing

eFlow104NX, eFlow104NX8(D), eFlow104NX16(D) Dimensions (H x W x D approximate)

15.5" x 12" x 4.5" (393.7mm x 304.8mm x 114.3mm)

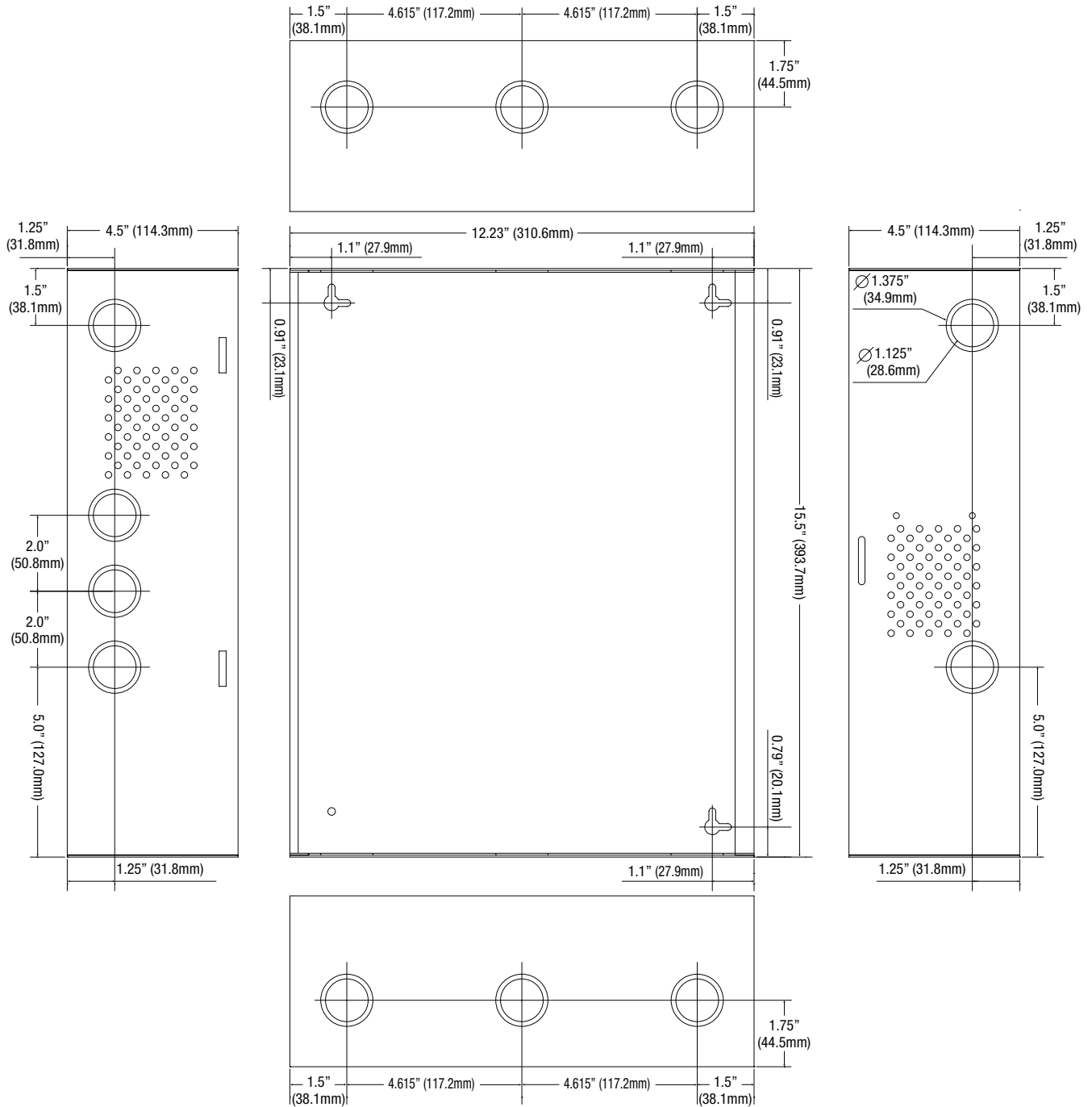

Lifetime Warranty

Altronix Corporation | 140 58th St | Brooklyn, NY 11220 USA

phone: +1 718.567.8181 | fax: +1 718.567.9056 | email: info@altronix.com | www.altronix.com