

# eFlow3N Series

## Power Supply/Chargers



Altronix eFlow3N series power supply/chargers convert a 120VAC 60Hz input into a single or four (4) fuse/PTC protected Class 2 power-limited outputs. Power supply/charger is selectable for 12VDC or 24VDC with a total of 2A max. It also offers a suite of features that includes fire alarm disconnect, overvoltage protection, and low power disconnect which prevents deep discharge of stand-by batteries.



eFlow3N4D

### Key Features

- Available with 1 or 4 outputs
- Fuse or PTC protected Class 2 power-limited outputs
- Additional aux. Class 2 power-limited output rated @ 1A
- Overvoltage protection
- Fire alarm disconnect
- Supervision
  - AC Fail
  - Battery Fail and Battery Presence
  - Low power shutdown
- Built-in charger for sealed lead acid or gel type batteries
- Instantaneous transfer to stand-by batteries
- Short circuit and overload protection
- AC input and DC output LED indicators
- UL Listed in the U.S. and Canada
- CE European Conformity
- Lifetime Warranty

### eFlow3N series Power Supply Configuration Reference Chart

Altronix Model Number	Input Rating: 120VAC, 60Hz	Input Fuse Rating	Battery Fuse Rating	Nominal DC Outputs				Maximum Supply Current for Main and Aux. Outputs (A)	Ripple Voltage (mV) Under low battery condition	Power Distribution Module	Number of Outputs	Fused Outputs Ratings	Auto-Resettable PTC Outputs Ratings	Accommodates up to 7AH Batteries	Accommodates up to 12AH Batteries
				[DC]		[AUX]									
				12VDC Output Range (V)	24VDC Output Range (V)	12VDC Output Range (V)	24VDC Output Range (V)								
eFlow3N	3.5A	5A/250V	3A/32V	10.13-13.2	20.28-26.39	10.15-13.2	20.2-26.39	2A	960	N/A	1	-	-	✓	-
eFlow3NX				-	-	-	✓								
eFlow3N4	3.5A	5A/250V	3A/32V	10.13-13.2	20.28-26.39	10.15-13.2	20.2-26.39	2A	960	PD4UL	4	2A	-	✓	-
eFlow3NX4				2A	-	-	✓								
eFlow3N4D	3.5A	5A/250V	3A/32V	9.78-13.2	20.28-26.39	10.15-13.2	20.2-26.39	2A	960	PD4ULCB	4	-	2A	✓	-
eFlow3NX4D				-	2A	-	✓								

#### Lifetime Warranty

## Specifications

### Input

Voltage 120VAC, 60Hz, 3.5A max.  
Fuse Rating 5A/250V

### Outputs

Voltage 12VDC or 24VDC selectable  
Current 2A continuous max.  
Protection Fused: 2A / PTC: 2A  
Auxiliary Class 2 power-limited @ 1A (unswitched)  
Other Overvoltage protection. Filtered and regulated

### Battery Charging

Capacity 7AH/12VDC (1 or 2 within enclosure)  
12AH/12VDC (requires larger "X" enclosure)  
40AH/65AH (requires separate enclosure)  
Type Sealed lead acid or gel type  
Fuse Rating 3A/32V  
Failover Upon AC loss, instantaneous  
Batteries are sold separately

### Fire Alarm Disconnect

Supervised Latching or non-latching  
EOL 10K Resistor

### Supervision

AC Failure Form "C" contacts  
Battery Form "C" contacts

### Low DC Power Shutdown

Shuts down DC output terminals if battery voltage drops below 71-73% for 12V units and 70-75% for 24V units (depending on the power supply)  
Prevents deep battery discharge

### Indicators (LED)

Input 1 20VAC is present  
DC Output Powered

## Agency Listings

### UL:

UL294 Access Control System Units  
UL603 Power Supplies for Use with Burglar-Alarms Systems  
UL1481 Power Supplies for Fire Protective Signaling Systems

### cUL:

ULC-S318-96 Power Supplies for Burglar Alarm Systems Also suitable for Access Control

### CSFM

California State Fire Marshall Approved

### CE

European Conformity

## Physical and Environmental

### Dimensions (H x W x D)

#### eFlow3N, eFlow3N4(D):

Enclosure: 13.5" x 13" x 3.25" (342.9mm x 330.2mm x 82.55mm)  
Shipping: 15" x 13.875" x 4.75" (381mm x 352.4mm x 120.6mm)

#### eFlow3NX, eFlow3NX4(D):

Enclosure: 15.5" x 12" x 4.5" (393.7mm x 304.8mm x 114.3mm)  
Shipping: 16.5" x 13.5" x 6" (419.1mm x 342.9mm x 152.5mm)

### Weight (approx.)

Model	Product Weight	Shipping Weight
eFlow3N	6.3 lb. (2.86 kg)	7.2 lb. (3.27 kg)
eFlow3NX	8.15 lb. (3.7 kg)	9.1 lb. (4.13 kg)
eFlow3N4(D)	6.45 lb. (2.93 kg)	7.35 lb. (3.33 kg)
eFlow3NX4(D)	8.3 lb. (3.76 kg)	9.6 lb. (4.2 kg)

### Temperature

Operating: 0°C to 49°C (32°F to 120°F)  
Storage: -20°C to 70°C (-4°F to 158°F)

### Relative Humidity

85% +/- 5%  
BTU/Hr (approx.) 12VDC: 12 BTU/Hr.  
24VDC: 25 BTU/Hr.

## Accessories (order separately)

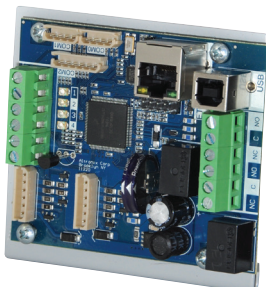

LINQ2

### LINQ2 - Network Supervision

Altronix LINQ2 Network Communication Module provides remote supervision, control and monitoring over LAN/WAN

- Remotely reports accurate power diagnostics
- Controls power and resets devices
- Reports system diagnostics via Email



### Lifetime Warranty

## Dimensions and Drawing

eFlow3N, eFlow3N4(D) Dimensions (H x W x D approximate)

13.5" x 13" x 3.25" (342.9mm x 330.2mm x 82.55mm)

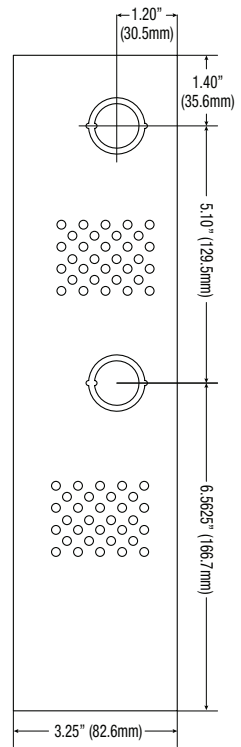
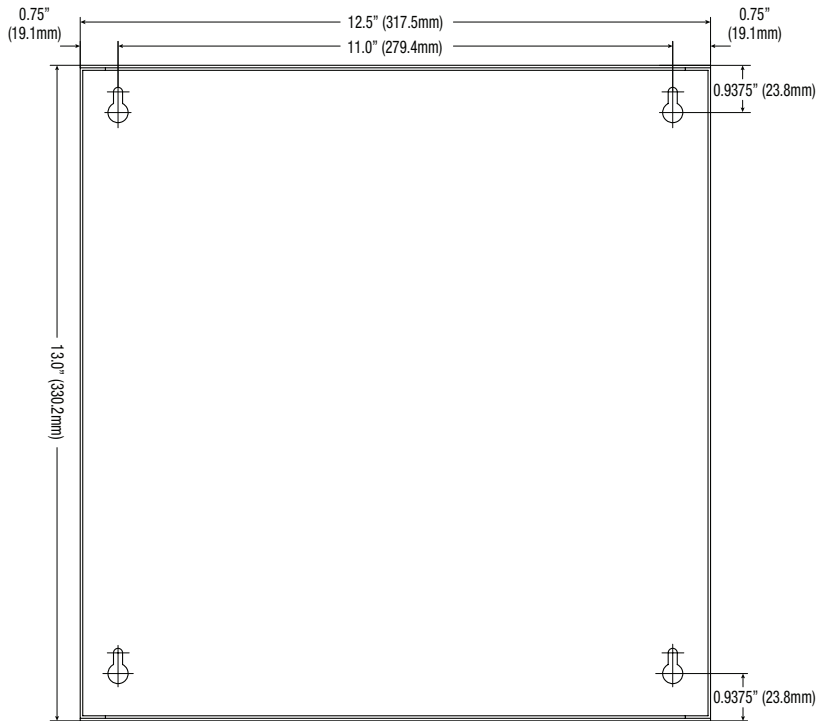
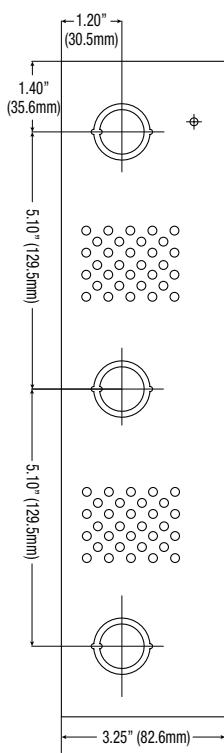
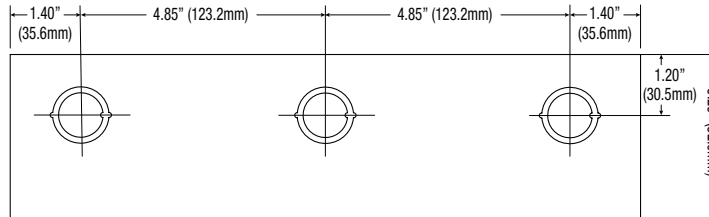

### Lifetime Warranty

Altronix Corporation | 140 58th St | Brooklyn, NY 11220 USA

phone: +1 718.567.8181 | fax: +1 718.567.9056 | email: info@altronix.com | www.altronix.com

## Dimensions and Drawing

eFlow3NX, eFlow3NX4(D) Dimensions (H x W x D approximate)

15.5" x 12" x 4.5" (393.7mm x 304.8mm x 114.3mm)

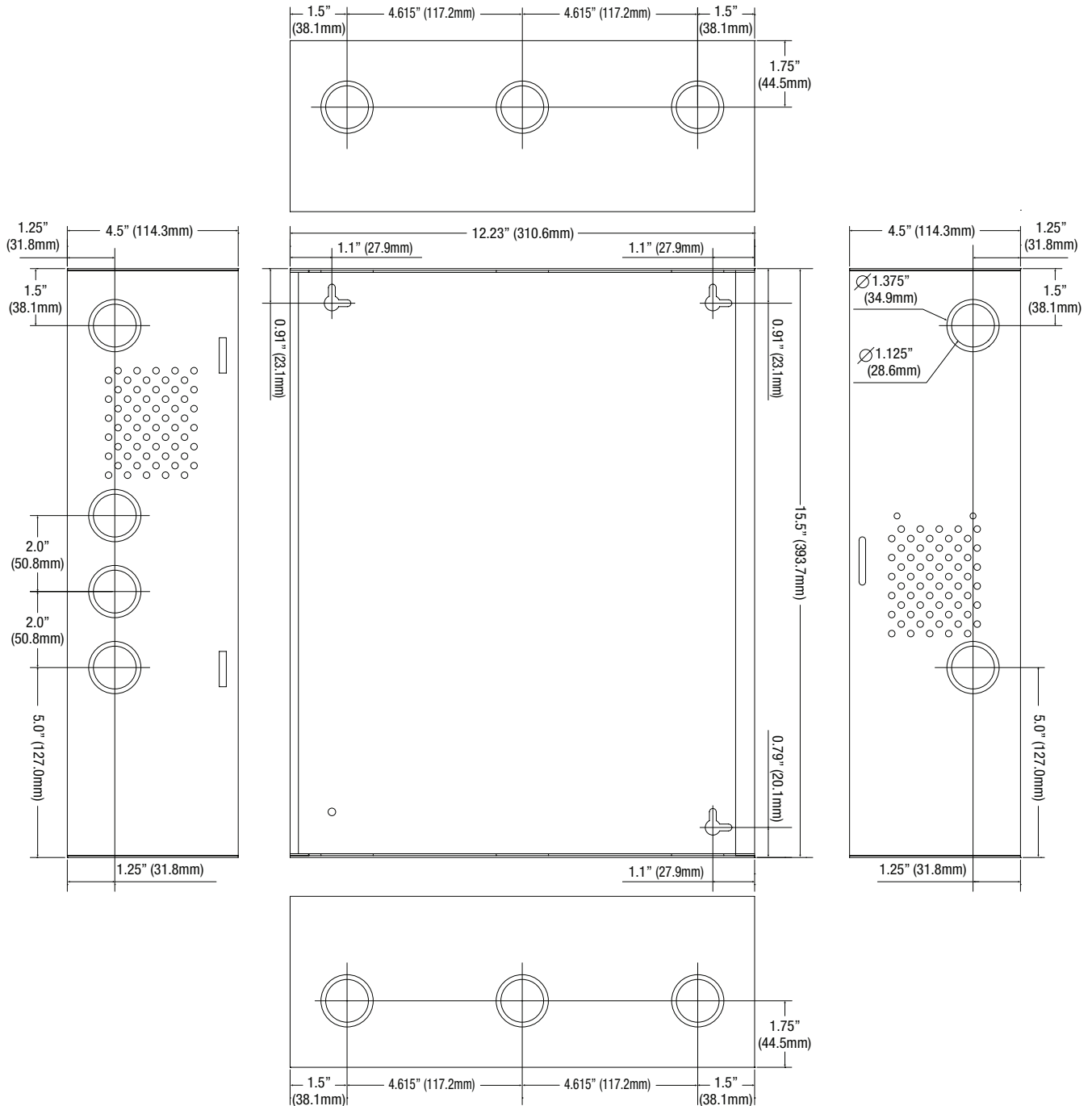

### Lifetime Warranty

Altronix Corporation | 140 58th St | Brooklyn, NY 11220 USA

phone: +1 718.567.8181 | fax: +1 718.567.9056 | email: info@altronix.com | www.altronix.com