



Access & Power Integration

## Altronix/Software House Rack Kits

### Models Include:

#### T1RSH3F8

8 Door Kit with Fused Outputs

Fully assembled kit includes:

- Trove1R rack enclosure with TSH1R Altronix/Software House backplane
- (1) eFlow6NB - Power Supply/Charger
- (1) VR6 - Voltage Regulator
- (1) ACMS8 - Fused Dual Input Access Power Controller

#### T1RSH3F8D

8 Door Kit with PTC Outputs

Fully assembled kit includes:

- Trove1R rack enclosure with TSH1R Altronix/Software House backplane
- (1) eFlow6NB - Power Supply/Charger
- (1) VR6 - Voltage Regulator
- (1) ACMS8CB - PTC Dual Input Access Power Controller

All components of these Trove kits are UL Listed sub-assemblies.

Please refer to the included corresponding Sub-Assembly Installation Guides for further information.

## Installation Guide



Rev. T1RSH3F8\_091523

More than just power.™

Installing Company: \_\_\_\_\_ Service Rep. Name: \_\_\_\_\_

Address: \_\_\_\_\_ Phone #: \_\_\_\_\_

## Overview:

Altronix Software House rack kits are pre-assembled and consist of Trove1SH1R enclosure/backplane with factory installed Altronix power supply/charger and sub-assemblies. These kits also accommodate various combinations of Software House boards for up to eight (8) doors in a single enclosure.

## Configuration Chart:

Altronix Model Number	120VAC 60Hz Input Current	Power Supply Board Input Fuse Rating	Power Supply Board Battery Fuse Rating	Nominal DC Output Voltage		Maximum Supply Current for Main and Aux. Outputs on Power Supply board and ACMS8(CB) Access Power Controller's outputs	Fail-Safe/ Fail-Secure or Dry Form "C" Outputs	ACMS8(CB) Board Input Fuse (PTC) Rating	ACMS8(CB) Board Output Fuse (PTC) Rating
				[DC]	[Aux]				
				Output Range (VDC)	Output Range (VDC)				
T1RSH3F8	3.5A	5A/ 250V	15A/ 32V	20.17- 26.4	20.28- 26.4	24VDC @ 5.4A	8	15A/ 32V	3A/ 32V
T1RSH3F8D								9A	2.5A

## Hardware and Accessories:

	Spacer		5/16" Pan Head Screw		Lock Nut
--	--------	---	----------------------	---	----------

## Specifications:

### Agency Listings:

- CE European Conformity.

### Mechanical:

- Black enclosure with ample knockouts for convenient access.
- Includes: tamper switch, cam lock and mounting hardware.
- Modular 2U standard EIA 19" drawer with extendable slides up to 48".
- Dimensions (H x W x D): 3.375" x 19.0" x 26.5" (85.8mm x 482.6mm x 673.1mm)

### Included Accessories:

- One (1) tamper switch (Altronix Model TS112 or equivalent).
- Cam lock.

### Available Accessories (not included):

- RE2: Rack Mount Battery Enclosure accommodates up to four (4) 12VDC/7AH batteries.
- WM5, WM25, WM100: Magnetic Cable Tie Mounts (5, 25, 100 counts).

## Installation Instructions for T1RSH3F8(D):

Wiring methods shall be in accordance with the National Electrical Code/NFPA 70/ANSI, and with all local codes and authorities having jurisdiction. These products are for indoor use only and must be installed within the protected premises.

**Note:** First assemble and install Z Bracket Wire Management Accessory (refer to Z Bracket Installation pg. 4)

1. Remove backplane from enclosure prior to installing into rack cabinet (do not discard hardware).
2. In order to mount included UL Listed tamper switch (Altronix Model TS112 or equivalent) turn the enclosure upside down. Punch out the knockout in designated location, on the back of the unit, from outside of the drawer (Fig. 1, pg. 3). Insert the tamper switch into the knockout from outside of the drawer with the button facing outwards and spaded connectors inside the drawer. Connect tamper switch wiring to the Access Control Panel input or the appropriate UL Listed reporting device.  
To activate alarm signal open the rack drawer.
3. Slide the rack enclosure into an open 2U location in the four post rack cabinet.
4. Utilizing proper fasteners attach front ears to the rack rails.
5. Attach the rear of the adjustable slides to the rear rails of the rack cabinet with the proper fasteners.
6. Secure the rack cover (Fig. 2a, pg. 3) and rack drawer to earth ground (Fig. 2b, pg. 3).

Fig. 1  
Back of the drawer,  
viewed from outside.

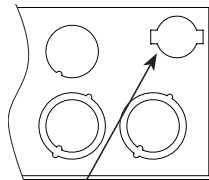

Tamper Switch  
mounting location

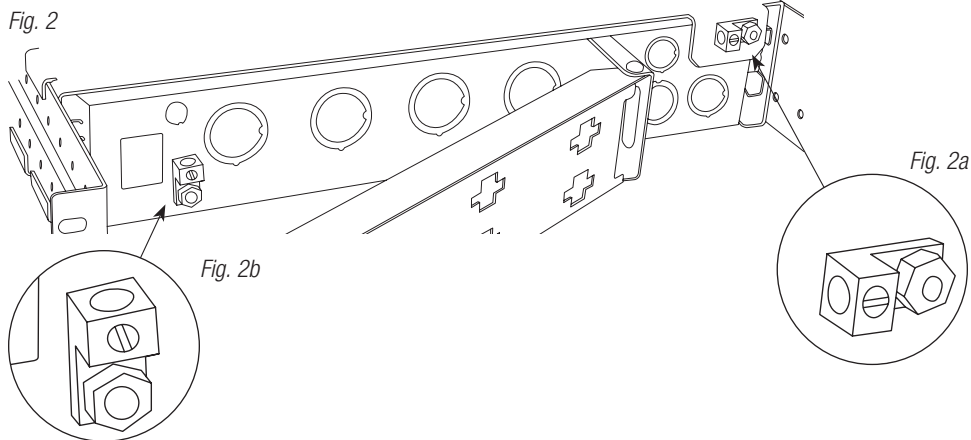

7. Ensure that all internal configurations (voltage selection, switch settings, etc.) are completed before mounting backplane back into Trove rack enclosure.
8. After all components are mounted on the backplane, attach it to the enclosure using included hardware.
9. Mount Software House modules to TSH1R backplane, refer to page 5.
10. Refer to the eFlow Power Supply/Charger Installation Guide for eFlow6NB and corresponding sub-assembly Installation Guides for the following models: ACMS8(CB), VR6 for further instructions.

## Assembling and Attaching Z Bracket Wire Management Accessory (included):

Altronix Trove Rack enclosures include Z Bracket, a convenient and reliable wire management accessory.

### Hardware (included):

 Ten (10) bolts and  eight (8) lock nuts.

1. Carefully unpack Z Bracket. Do not discard hardware (included) (*Fig. 3, pg. 4*).
2. Attach arms to each other using bolts and lock nuts (*Fig. 3a, pg. 4*).
3. Attach the hinge brackets to the ends of arms using bolts and nuts positioning them as shown on (*Fig. 3b, pg. 4*).
4. Make sure that all nuts are tightened.

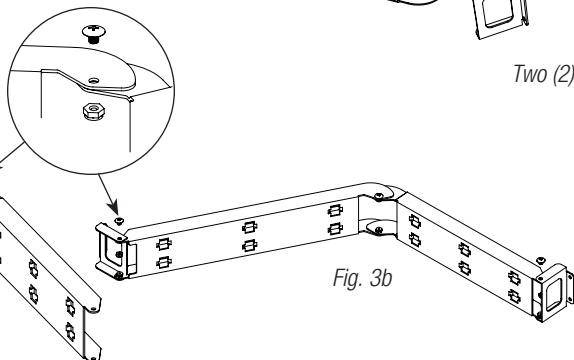
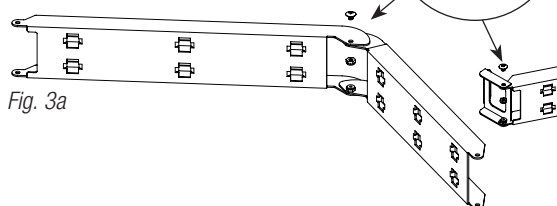
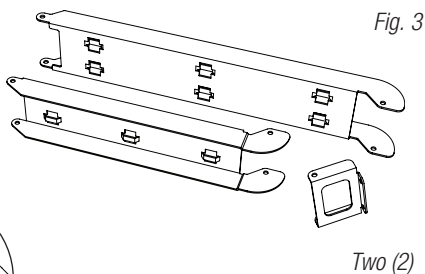

5. Attach the hinge bracket on the longer side of Z Bracket to the adjustable slide using bolts and lock nuts (included) (*Fig. 4, 4a, pg. 4*).
6. Attach the hinge bracket on the shorter side of Z Bracket to the rear of the rack enclosure using bolts (included).

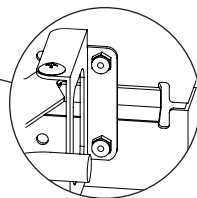
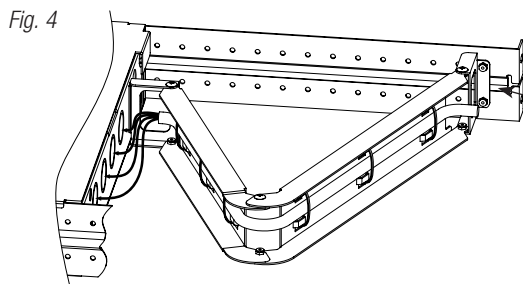

## T1RSH3F8(D):

### Configuration of Software House Modules

1. Fasten spacers onto metal pems configuration (A), (B), or (C) of backplane depending on the access controller (Fig. 5, pg. 5).
2. Position access controller module over corresponding spacers and fasten screws into spacers (Fig. 5a, pg. 5).  
**Note:** Software House iSTAR Ultra ACM and iSTAR ACM SE/ACM PRO boards have one (1) USB port each. Please orient boards in the appropriate position according to the Fig. 5 below.
3. Mount backplane to enclosure with hardware.

### Access Controller Position Chart for the Following Models:

Software House Access Controller	Pem Mounting
iSTAR Ultra ACM	A
iSTAR ACM SE/ACM PRO	B
I8, R8 or I8-CSI Module	C

Fig. 5

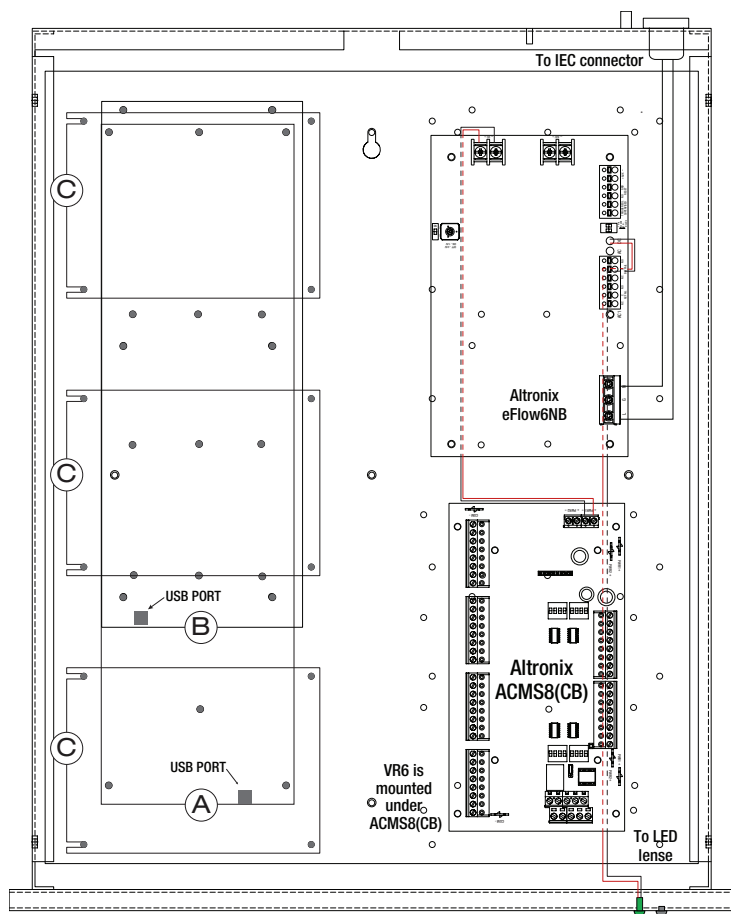
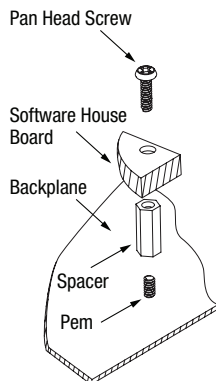

Fig. 5a



**Notes:**

**Notes:**

# Trove1R Enclosure Dimensions:

3.375" x 19.0" x 26.5" (85.8mm x 482.6mm x 673.1mm). Shown with Z Bracket attached.

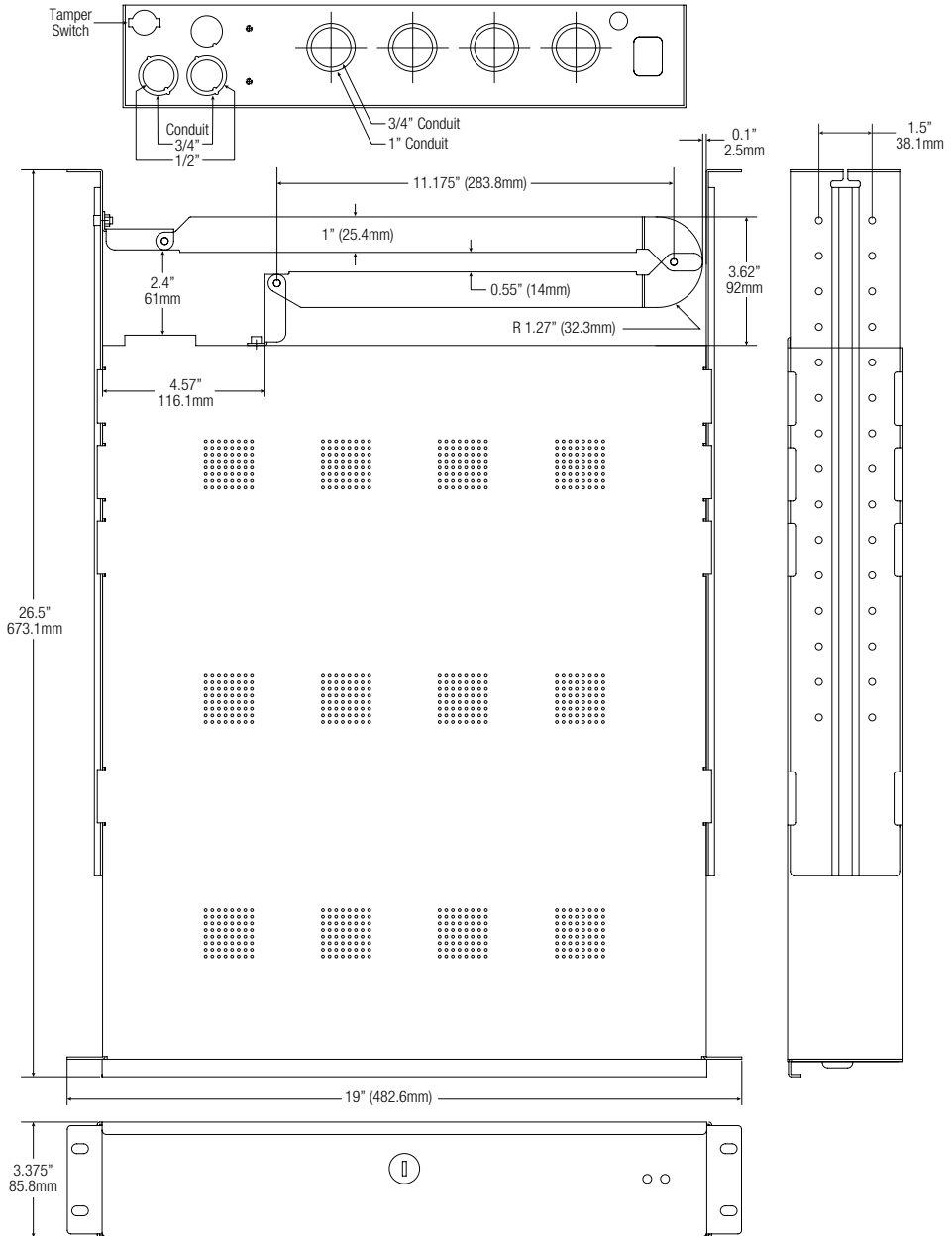

Altronix is not responsible for any typographical errors.

140 58th Street, Brooklyn, New York 11220 USA | phone: 718-567-8181 | fax: 718-567-9056  
 website: [www.altronix.com](http://www.altronix.com) | e-mail: [info@altronix.com](mailto:info@altronix.com) | Lifetime Warranty  
 IIT1RS3F8(D) H5W

