

Access & Power Integration

Altronix/HID Aero Wired Kits

Models Include:

T3V77XK1

16 Door Kit with Fused Outputs

Fully assembled kit includes:

- Trove3 enclosure with TV3 Altronix/HID Aero backplane
- Two (2) eFlow104NB - Power Supply/Chargers
- Two (2) VR10 - Voltage Regulators
- Two (2) ACMS8 - Dual Input Fused Access Power Controllers
- Three (3) PDS16 - Dual Input Fused Power Distribution Modules
- One (1) Rocker Switch Bracket with Two (2) Rocker Switches
- Wire harnesses and finger ducts for one (1) X1100 and seven (7) X100

T3V77XK1D

16 Door Kit with PTC Outputs

Fully assembled kit includes:

- Trove3 enclosure with TV3 Altronix/HID Aero backplane
- Two (2) eFlow104NB - Power Supply/Chargers
- Two (2) VR10 - Voltage Regulators
- Two (2) ACMS8CB - Dual Input PTC Access Power Controllers
- Three (3) PDS16CB - Dual Input PTC Power Distribution Modules
- One (1) Rocker Switch Bracket with Two (2) Rocker Switches
- Wire harnesses and finger ducts for one (1) X1100 and seven (7) X100

Please refer to the included corresponding Sub-Assembly Installation Guides for further information.

Installation Guide



All registered trademarks are property of their respective owners.

Rev. 121923

Installing Company: _____ Service Rep. Name: _____

Address: _____ Phone #: _____



More than just power.™

Overview:

Altronix T3V77XK1(D) Trove HID Aero kit is pre-assembled and consists of Trove enclosure/backplane with factory installed Altronix power supply/chargers and sub-assemblies. It also accommodates a variety of HID Aero modules for up to sixteen doors in a single enclosure.

Configuration Chart:

Altronix Model Number	120VAC 60Hz Input Current (A)	Power Supply Board Input Fuse Rating	Power Supply Board Battery Fuse Rating	Maximum Supply Current for Main and Aux. Outputs on Power Supply board and ACMS8(CB) Access Power Controllers' outputs	Nominal DC Output Voltage		Fail-Safe/Fail-Secure Outputs	Additional Fuse (PTC) Protected Outputs	ACMS8(CB) Board Input Fuse (PTC) Rating	ACM4(CB) Board Output Fuse (PTC) Rating	PDS16(CB) Board Input Fuse (PTC) Rating	PDS16(CB) Board Output Fuse (PTC) Rating
					[DC]	[Aux]						
					Output Range (VDC)	Output Range (VDC)						
T3V77XK1	9	6.3A/250V	15A/32V	24VDC @ 9.7A	20.17-26.4	20.28-26.4	16	48	15A/32V	3A/32V	15A/32V	3A/32V
T3V77XK1D									9A	2.5A	9A	2.5A

Installation Instructions:

Wiring methods shall be in accordance with the National Electrical Code/NFPA 70/ANSI, and with all local codes and authorities having jurisdiction. Product is intended for indoor use only.

1. Remove backplane from enclosure. Do not discard hardware.
2. Mark and predrill holes in the wall to line up with the top three keyholes in the enclosure. Install three upper fasteners and screws in the wall with the screw heads protruding. Place the enclosure's upper keyholes over the three upper screws; level and secure. Mark the position of the lower three holes. Remove the enclosure. Drill the lower holes and install the three fasteners. Place the enclosure's upper keyholes over the three upper screws. Install the three lower screws and make sure to tighten all screws.
3. Mount included UL Listed tamper switch (Altronix Model TS112 or equivalent) in desired location, opposite hinge. Slide the tamper switch bracket onto the edge of the enclosure approximately 2" from the right side (*Fig. 1, pg. 2*). Connect tamper switch wiring to the Access Control Panel input or the appropriate UL Listed reporting device. To activate alarm signal open the door of the enclosure.
4. Mount HID Aero modules to backplane(s), refer to *page 3*.
5. Refer to the *eFlow Power Supply/Charger Installation Guide* for eFlow104NB and corresponding *Installation Guides* for PDS16(CB), VR6, ACMS8(CB) for further installation instructions.

Hardware:



 Nylon Spacer |  7/8" Pan Head Screw |  Lock Nut

Fig. 1



T3V77XK1 and T3V77XK1D: Installation Instructions for HID Aero Access Controllers

1. Fasten spacers (provided) onto metal pems configuration (A), (B), (C), (D), (E), (F), (G), (H), (I), (J) of backplane (Fig. 2, pg. 3).
2. Mount HID Aero modules to spacers utilizing 7/8" pan head screws (provided) (Fig. 2a, pg. 3).
3. Fasten backplane to Trove3 enclosure utilizing hardware (provided).

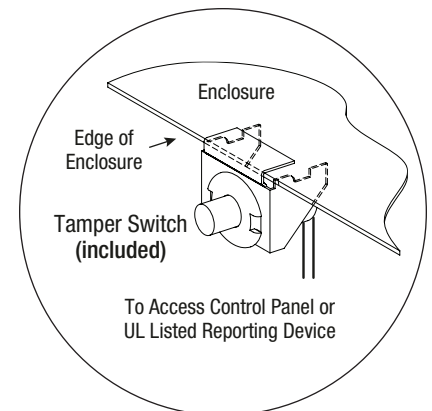
Fig. 2

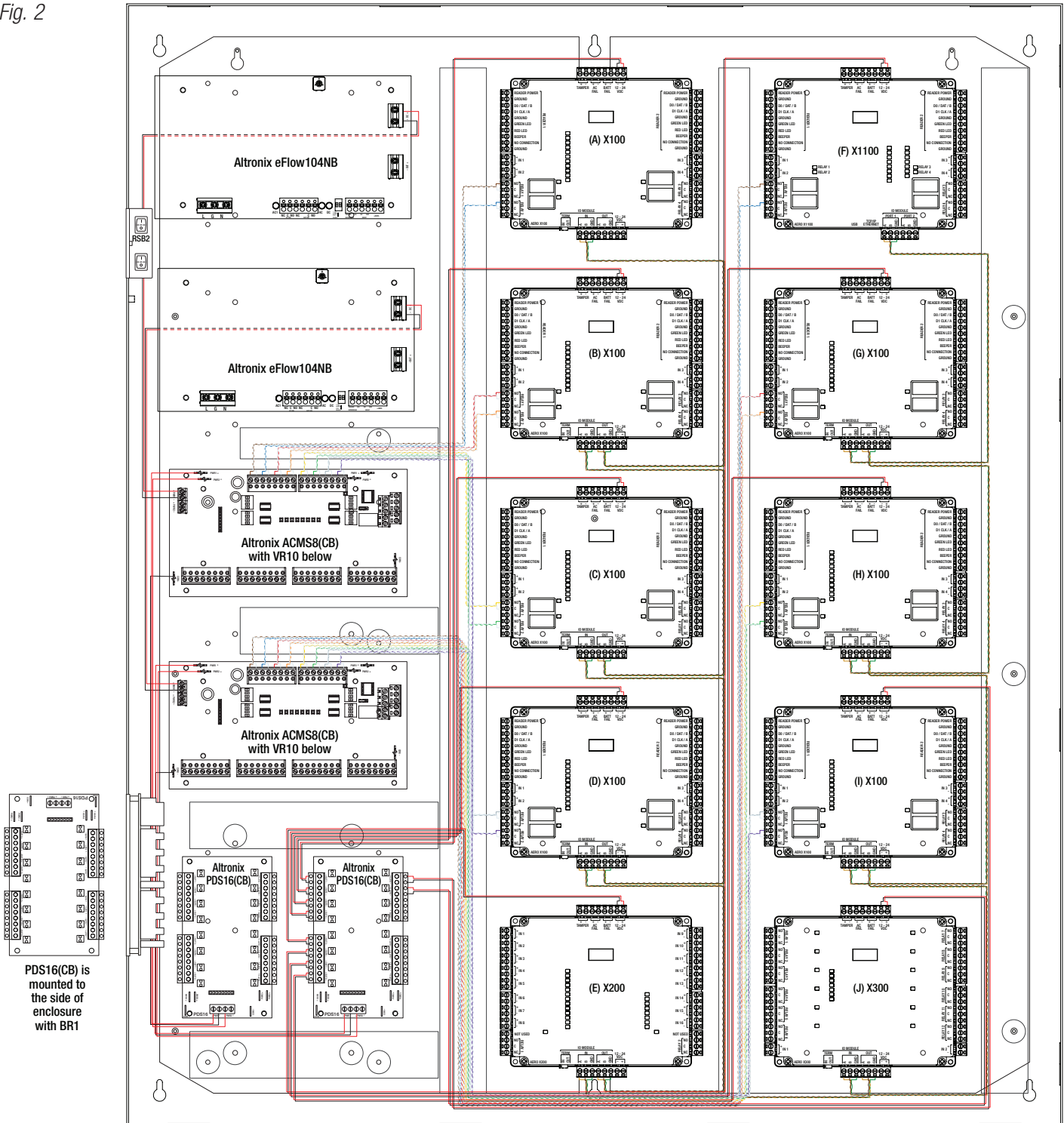
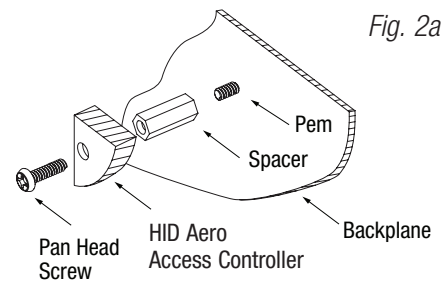
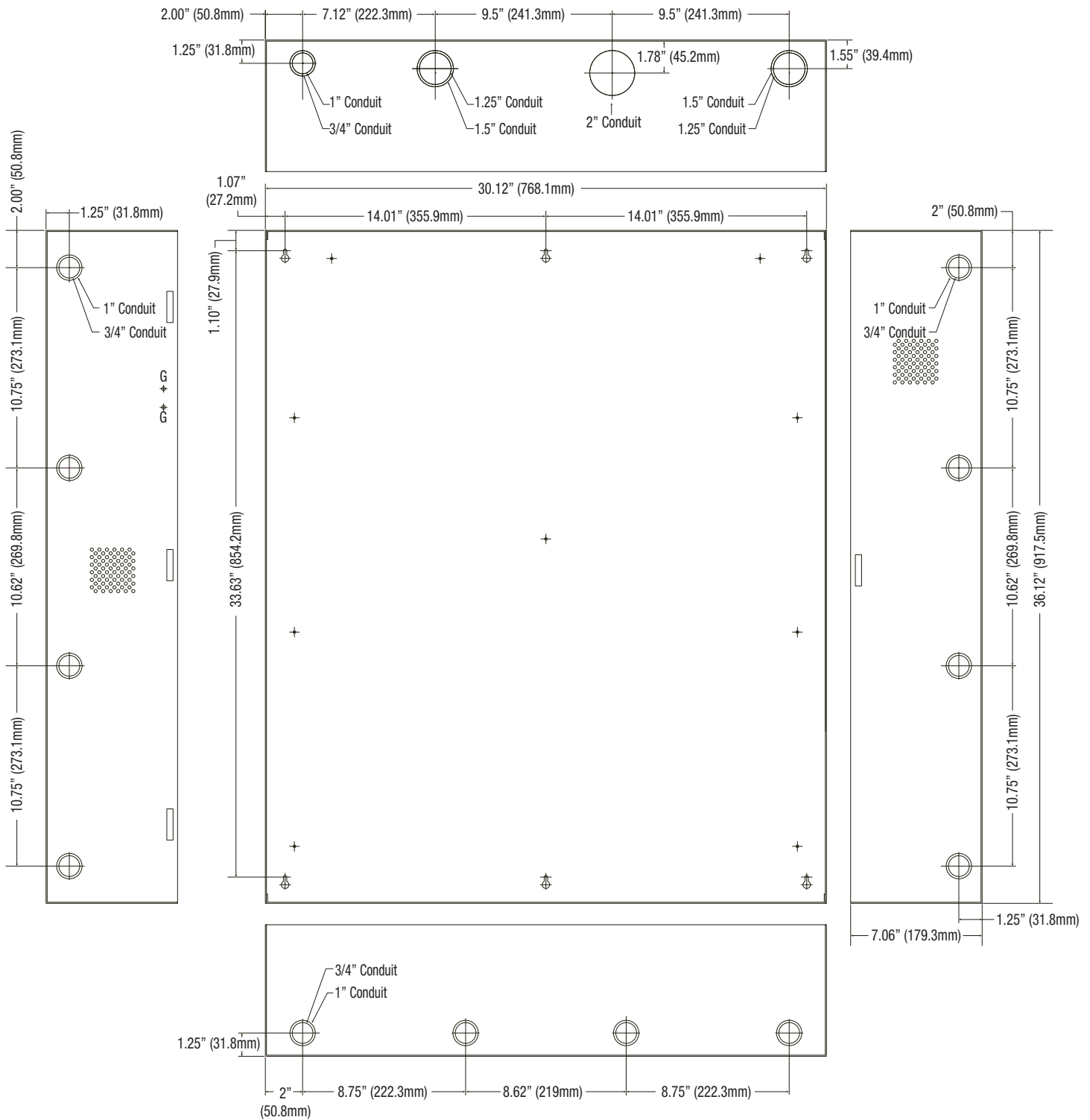

Fig. 2a



Trove3 Enclosure Dimensions (H x W x D approximate):

36.12" x 30.125" x 7.06" (917.5mm x 768.1mm x 179.3mm)



Altronix is not responsible for any typographical errors. Product specifications are subject to change without notice.

140 58th Street, Brooklyn, New York 11220 USA | phone: 718-567-8181 | fax: 718-567-9056
 website: www.altronix.com | e-mail: info@altronix.com | Lifetime Warranty
 IIT3V77XK1(D)

L19W



T3V77XK1(D) Installation Guide